

EN

Numatic



Nu-Clean Compact 220NX NCC.220.NX

COMPACT
SCRUBBER DRYER

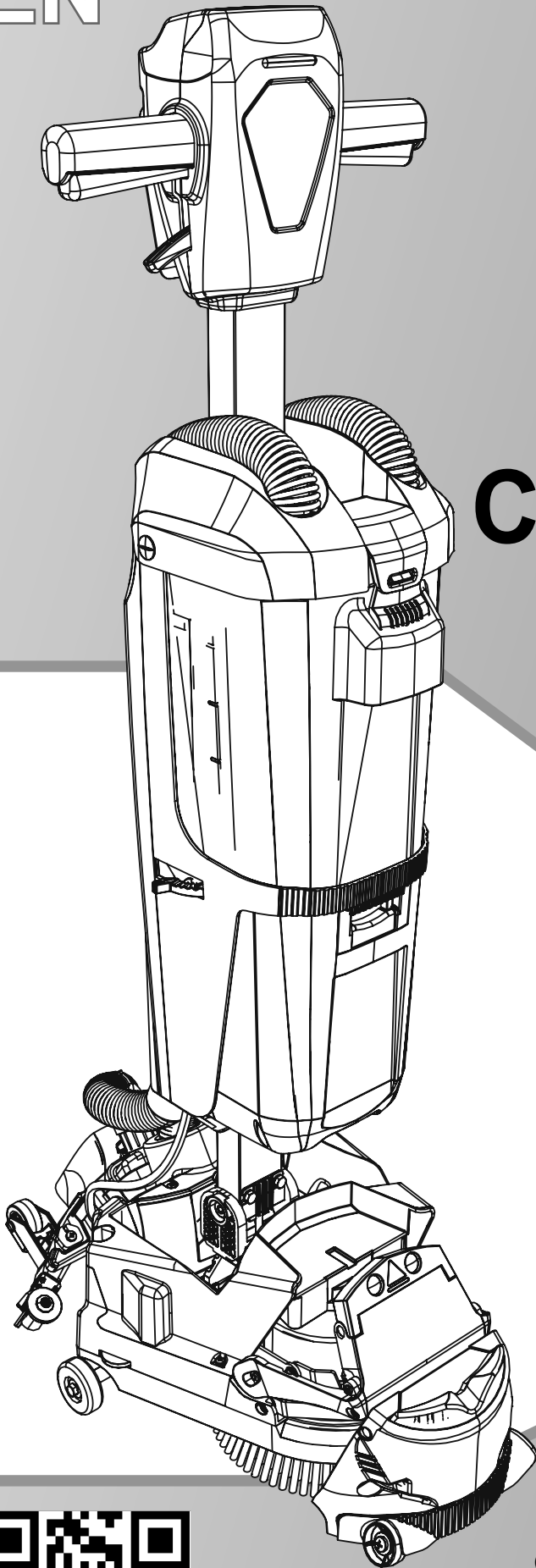

Original Instructions

CAUTION, Read instructions before using the machine
Keep for future reference



Numatic
Nu-Assist



numatic.com

Index

Machine Overview	Pages 2 & 3
Control Panel Overview	Page 4
Quick Set up Guide	Pages 5 - 8
Brush fitting	Page 5
Floor tool and vacuum hose fitting	Page 5
Main tank assembly removal	Page 5
Clean water tank removal & filling	Page 6
Battery fitting & water flow setting	Page 7
Machine handle operation	Page 9
Storage & Transportation	Page 10
Regular maintenance	Page 11 - 13
Separator removal & cleaning	Page 11
Clean water tank outlet cleaning	Page 12
Emptying Tanks	Page 12
Clean fluid trap	Page 13
Changing the floor tool blades	Page 14
Refitting the floor tool blades	Page 14
Battery removal & charging	Page 15
Removing the battery	Page 15
Battery Charging	Page 15
Schematic Diagram	Page 15
Specifications	Page 16
Troubleshooting	Page 16
Rating Label / Personal Protective Equipment / Recycling	Page 17
Information for Scrubber Dryer	Page 18
Battery Information	Pages 19 - 22
Recommended Spare Parts	Page 22
EU Declaration Document	Page 23
Company Address	Page 24

**PLEASE READ
BEFORE COMMENCING
OPERATION.
KEEP FOR FUTURE REFERENCE**

**After the removal of all the packaging,
carefully open and check the contents**

- Owner Manual
- Battery Charger & Lead
- Battery Pack • Scrub Brush
- Squeegee Assembly

Machine Overview	
1	Operator control panel
2	Triggers
3	Waste-water tank
4	Clean-water tank
5	Brush deck
6	Squeegee blades
7	Clean water flow adjustment taps
8	Clean-water filling / emptying cap
9	Floor tool vacuum hose
10	Vacuum hose
11	Separator
12	Battery
13	Battery charger
14	Clean tank fill view windows
15	Fluid trap
16	Floor tool toe cap
17	Transport / Storage wheels
18	Battery compartment

In the event of a breakdown contact
your Numatic dealer or the
Numatic Technical
help line +44 (0)1460 269268

Machine Overview

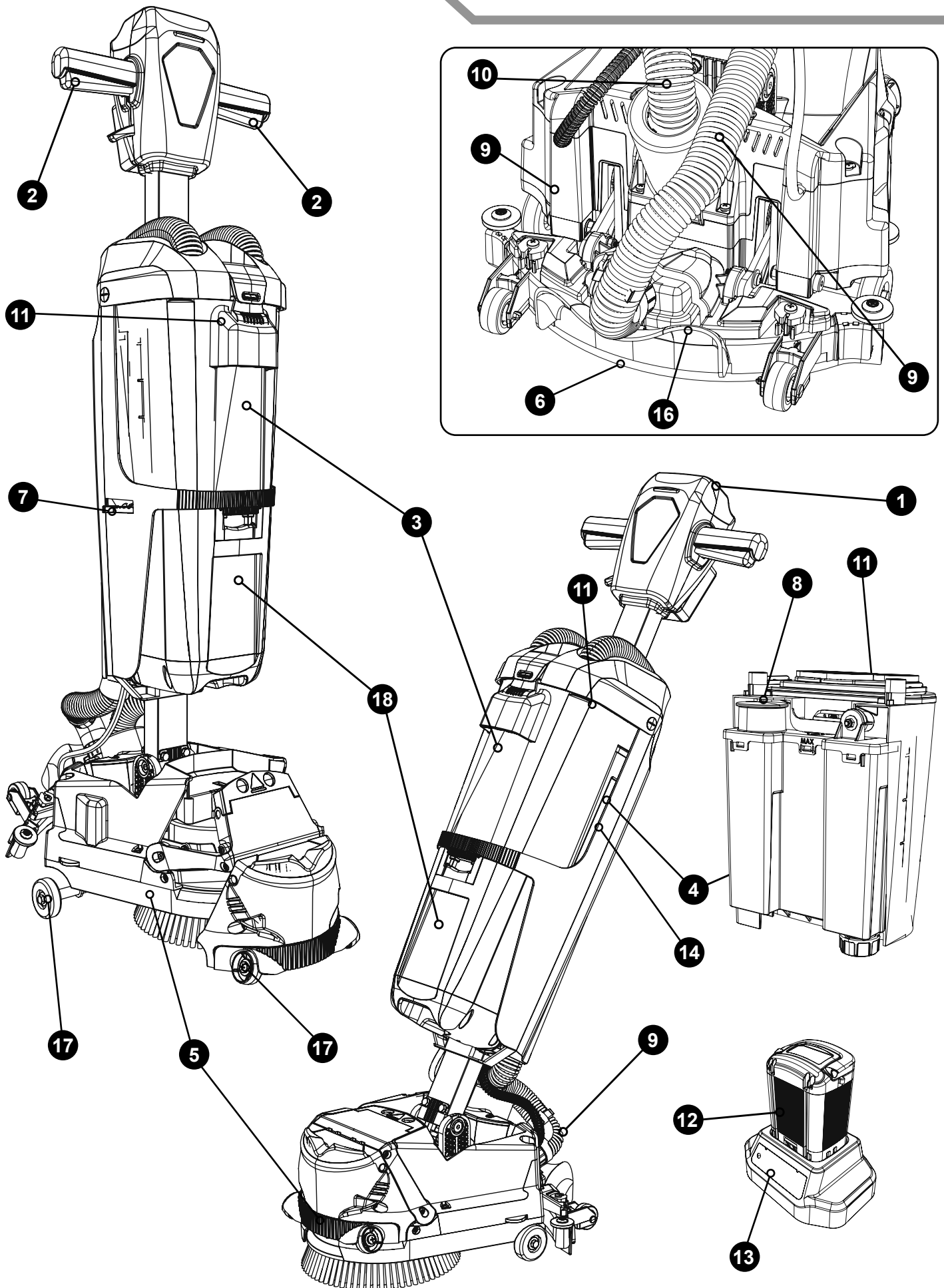

Control Panel Overview

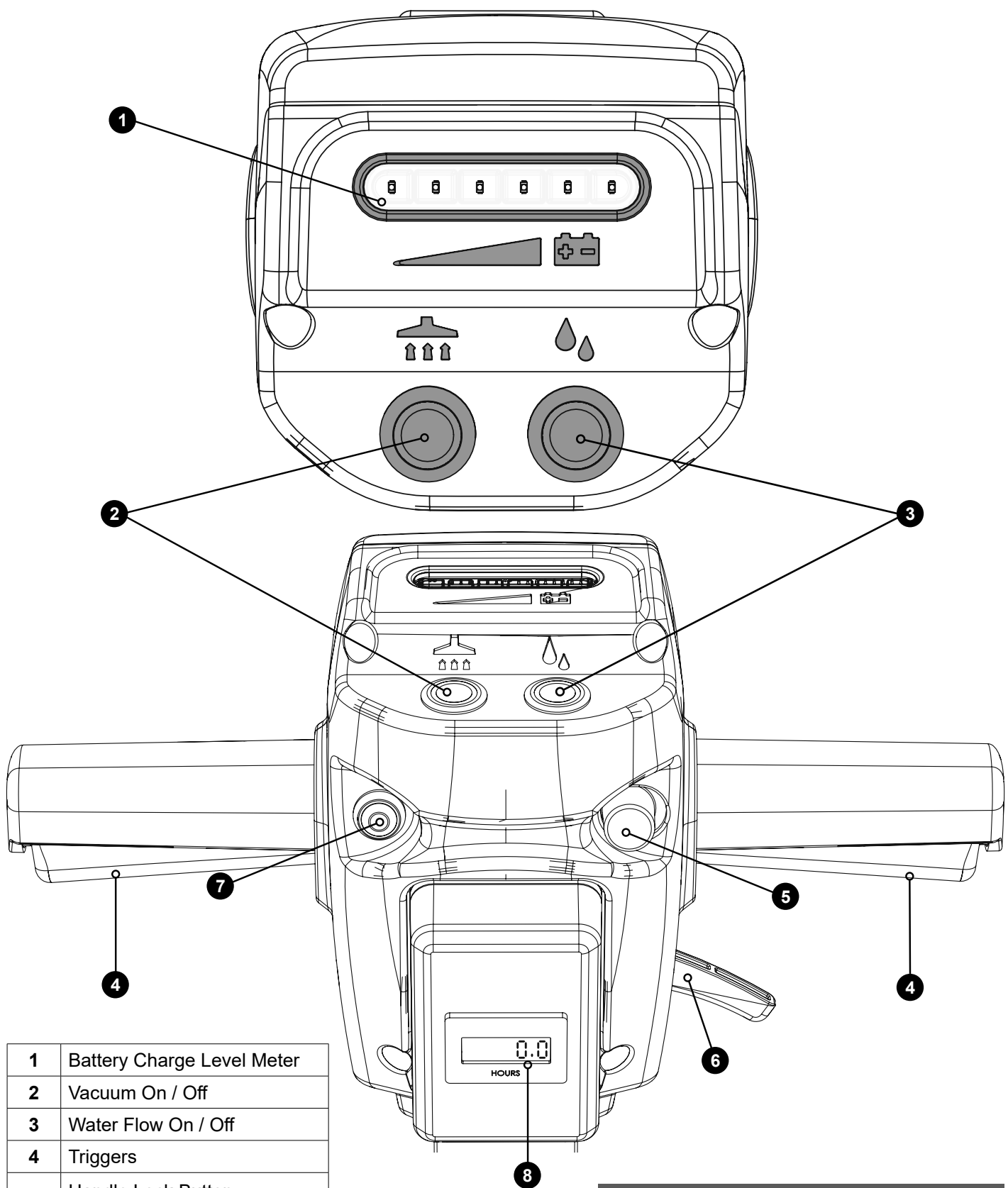

1	Battery Charge Level Meter
2	Vacuum On / Off
3	Water Flow On / Off
4	Triggers
5	Handle Lock Button (In the upright position)
6	Handle Release Lever
7	Start Button
8	Hours Meter

In the event of a breakdown contact
your Numatic dealer or the
Numatic Technical
helpline +44 (0)1460 269268

Quick Set-up Guide

CONTENTS

- Owner Manual
- Battery Charger & Lead
 - Battery Pack
 - Scrub Brush
- Squeegee Assembly



PLEASE READ BEFORE COMMENCING ANY OPERATION AFTER THE REMOVAL OF ALL THE PACKAGING, CAREFULLY OPEN AND CHECK THE CONTENTS.



Main tank assembly removal

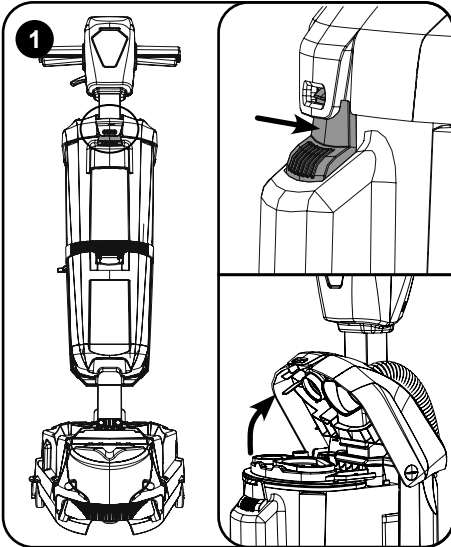

Remove the tank assembly from the front of the machine. Press button at the top on front of the tank assembly (A), lift the tank assembly up towards the main handle and out.

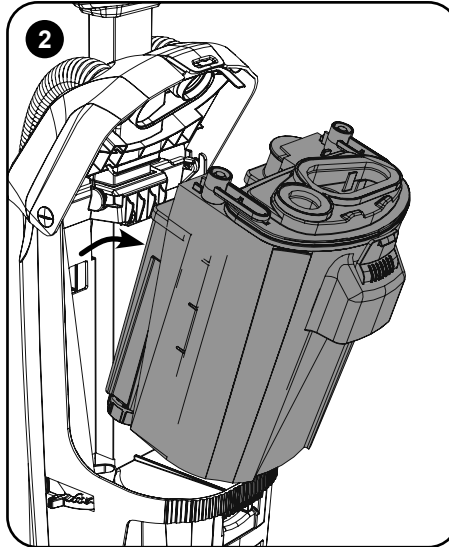

Lift and tilt the top of the tank assembly away from the handle as you remove. Place the tank assembly on a suitable surface in its upright/uppermost position.

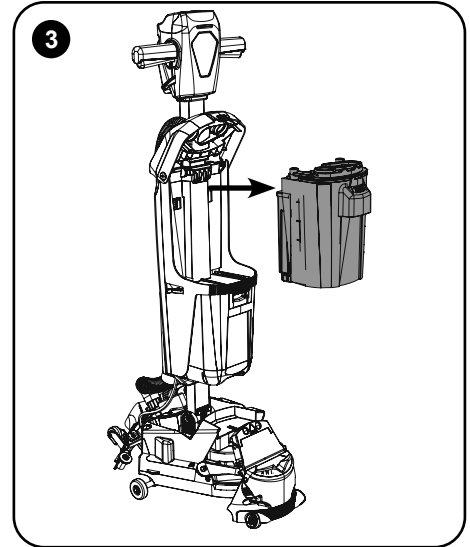

Brush Fitting

Make sure battery is removed before fitting or removing brushes.

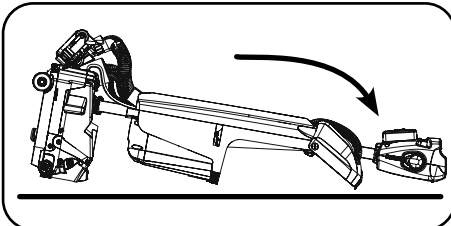

Make sure the handle is locked in upright position and storage wheels are retracted. Remove the tank assembly (and battery if fitted) gently lay machine on its front

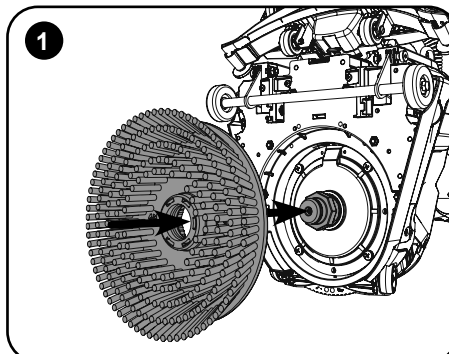

Push the brush / pad holder onto the brush motor mount (1 & 2). Note: Gloves are recommended to be worn whilst fitting and removing the brushes.

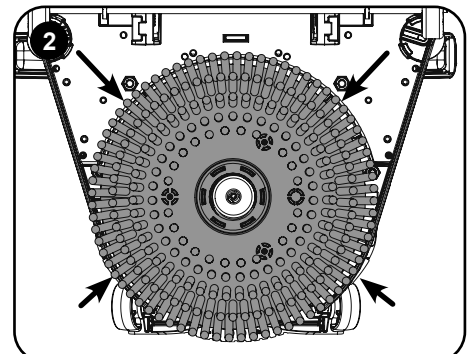

To remove the brush, place your fingers behind the brush deck in locations shown and gently wiggle off.

Floor tool and vacuum hose fitting

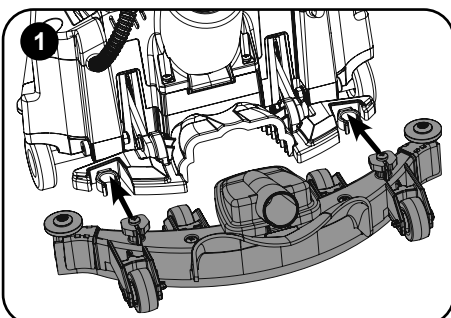

Push the floor tool carrier down and push the floor tool onto the retaining clips (1 & 2).

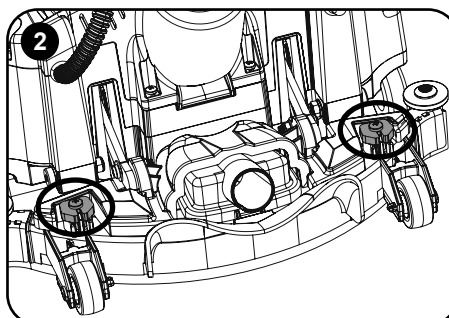

Take the hose and fit it securely over the centre fitting on the floor tool. Follow the arrows for the correct fit, making sure that the positioning collar is outside of the machine. Make sure hose stays loose and is not over stretched.

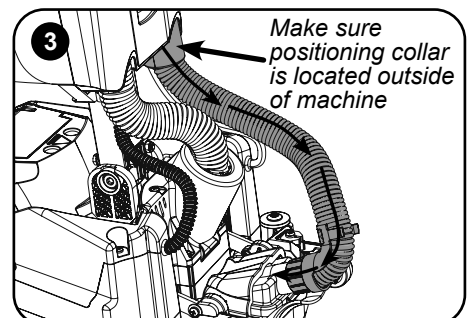

Quick Set-up Guide

Clean water tank removal and filling

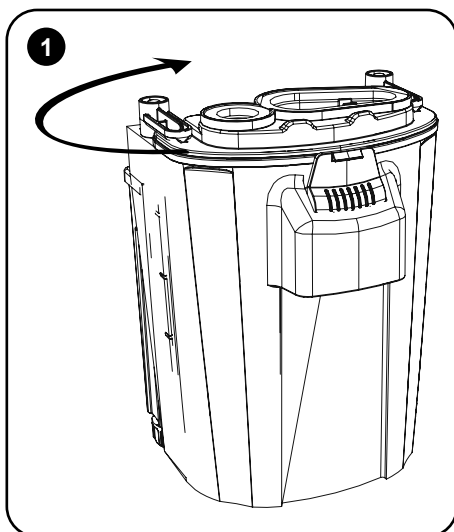

After lifting onto a suitable work surface, turn tank assembly

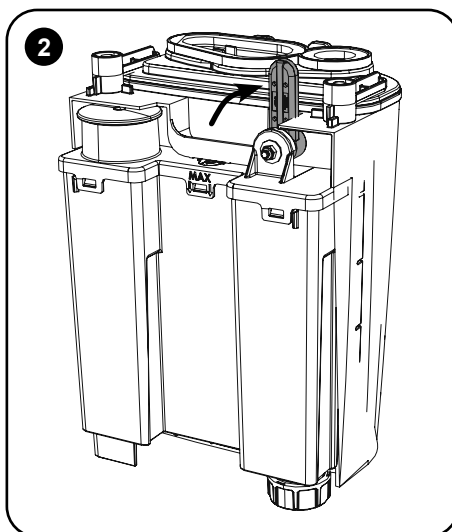

Turn clean water tank lock to release clean water tank.

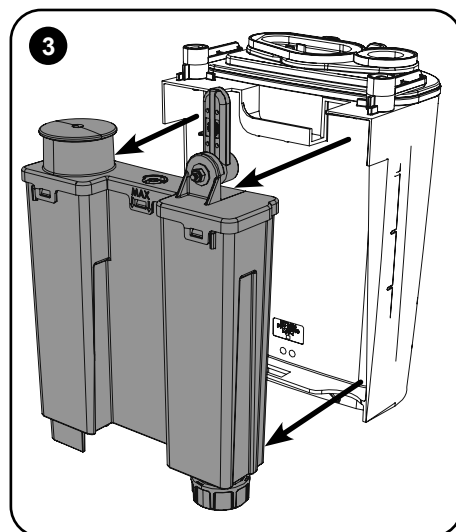

Remove the clean water tank from the tank assembly.

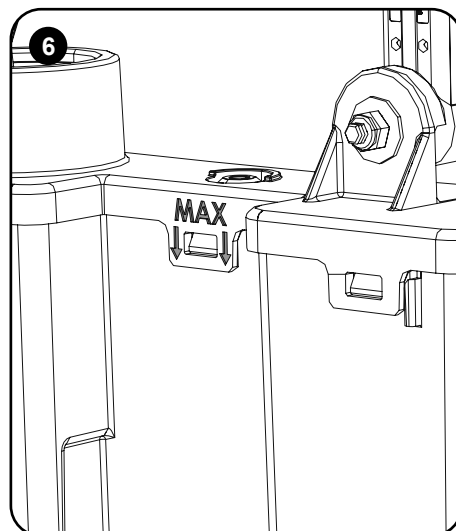
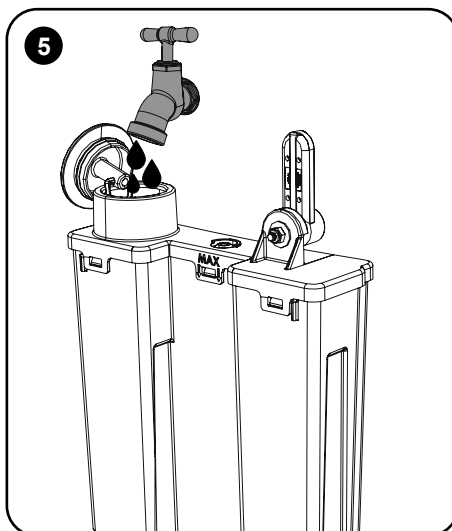
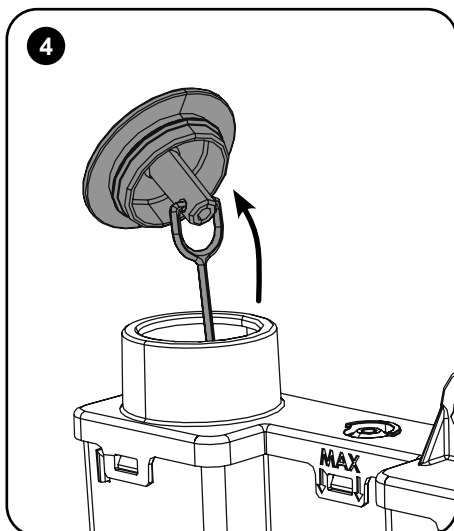

To fill remove the rubber stop from the filling neck. Note: There is a T piece keeping the rubber stop from being completely removed. Pour in the chemical (follow chemical manufactures dilution rates). Only fill the tank to the MAX fill line with clean water using a tap, hose or suitable water container. **DO NOT OVER FILL.**

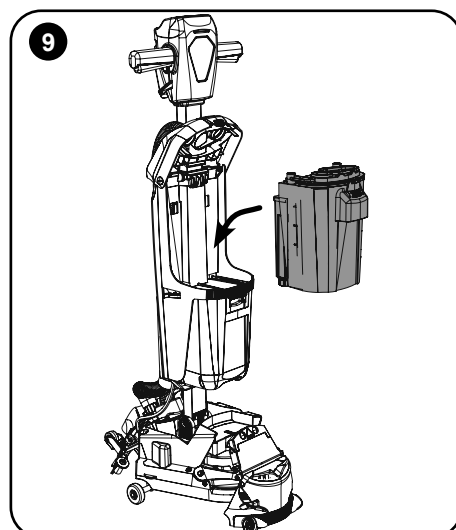
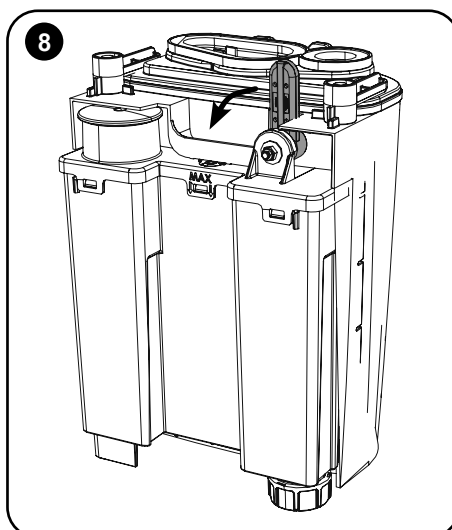
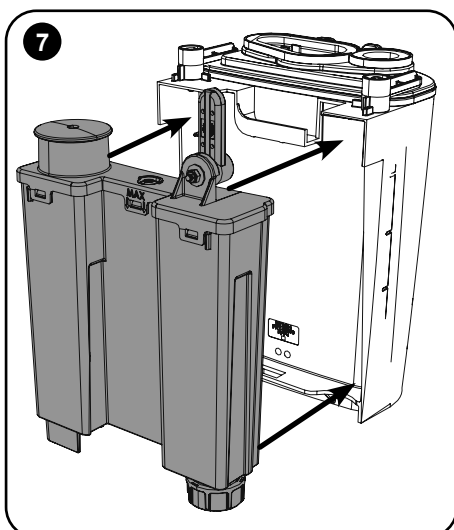

Place the tank back into the main tank body and turn lock to hold in place. Make sure it is securely fitted before fitting the tank assembly back on the machine.

Quick Set-up Guide

Battery fitting and water flow settings

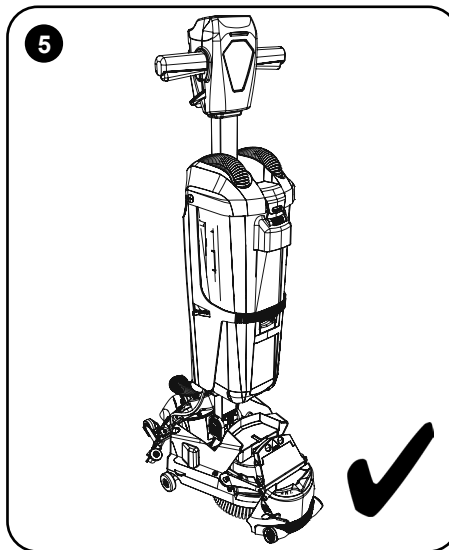
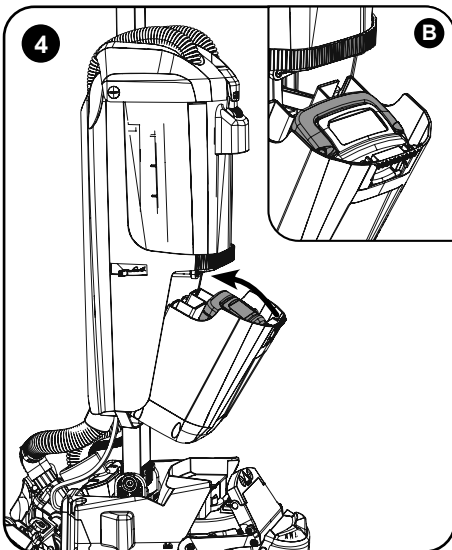
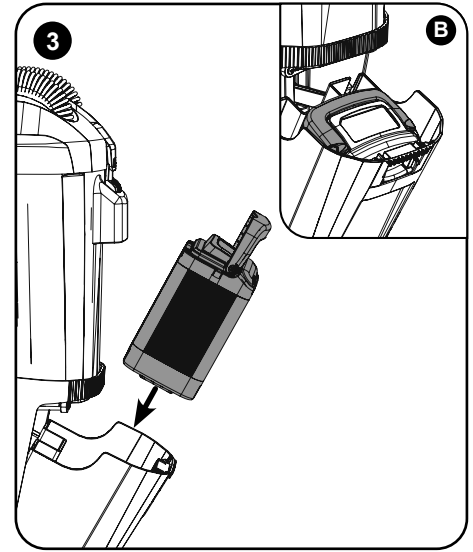
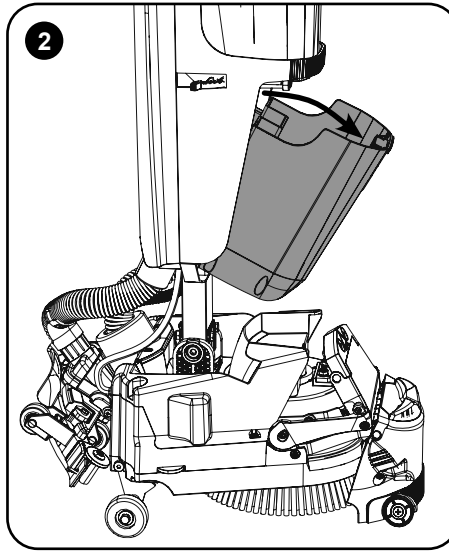
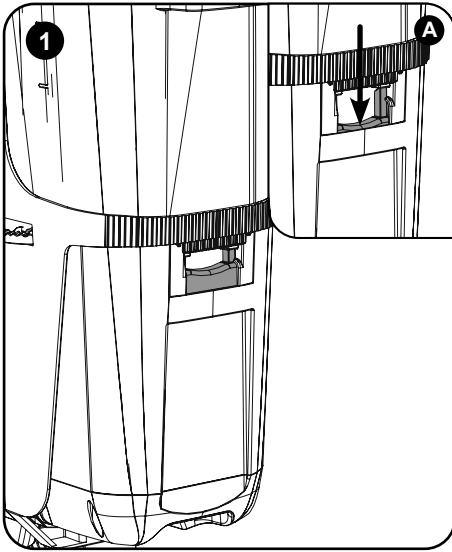

While holding down the battery compartment latch (A), tip battery compartment forward.

Lift the battery using the battery handle. Place the battery into the battery compartment ensuring it is securely in place and the orientation is correct (battery handle folds down towards the machine handle (B)).

Tip battery compartment back into place until latch clips closed.

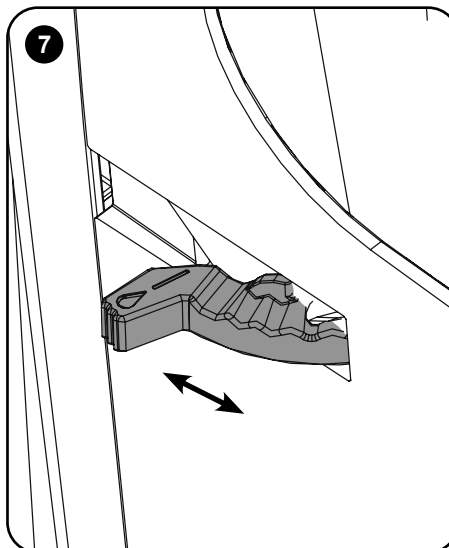
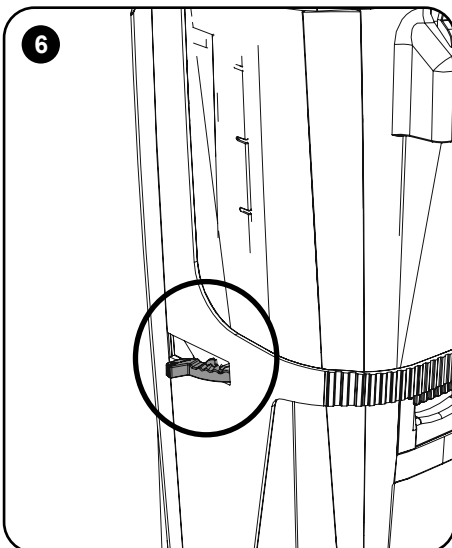

Located on the right side of the machine is the water flow control tap.

Push the fluid control lever to set the desired flow required, this will vary depending on what brush / pad and floor type the machine is being used on.

Note: On first use open the water tap fully and run the machine for a short period to purge the water flow then adjust tap to desired flow.

Quick Set-up Guide

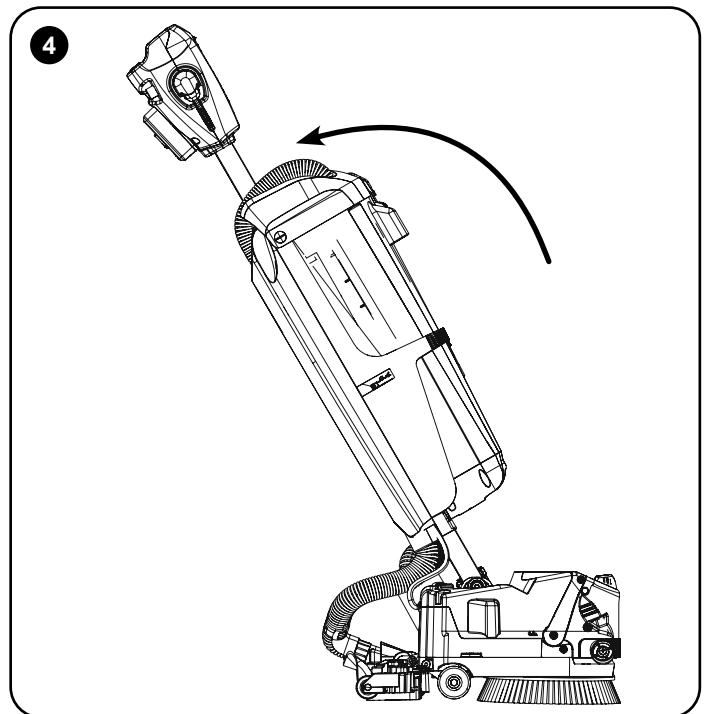
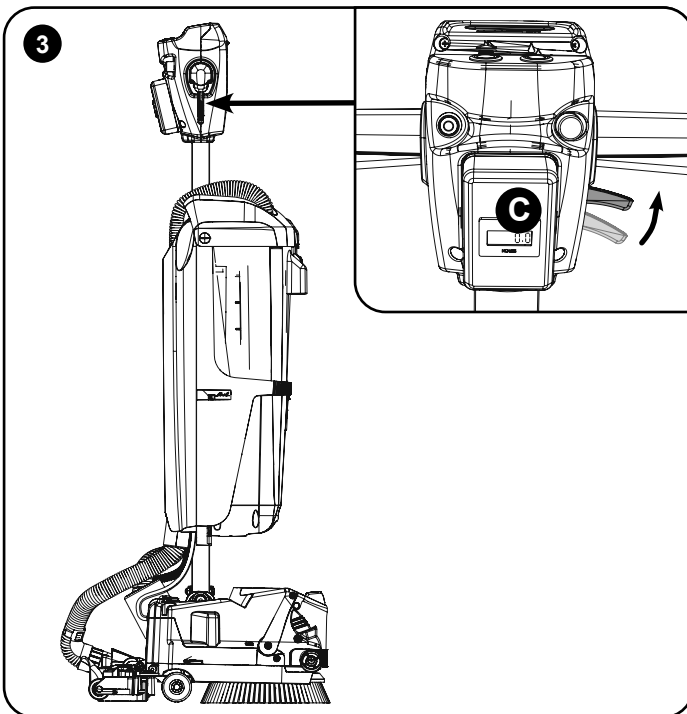
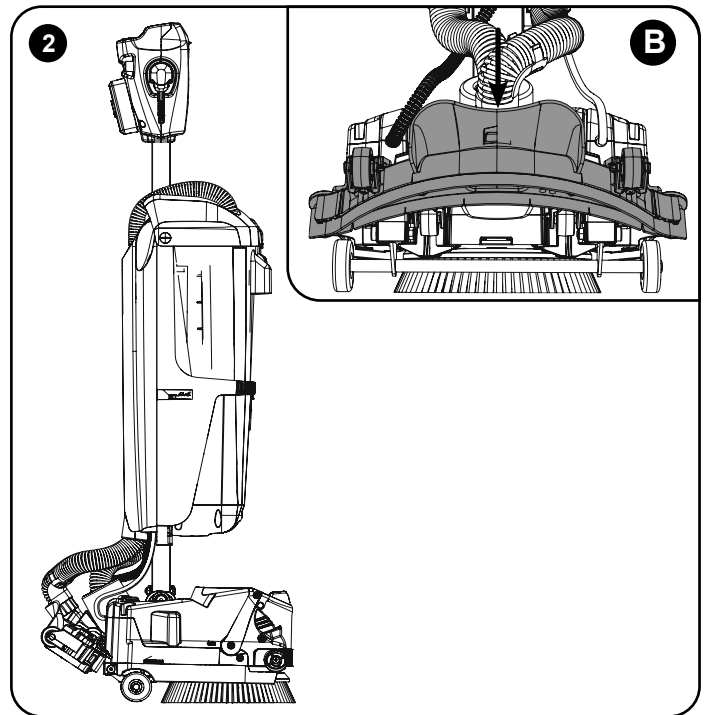
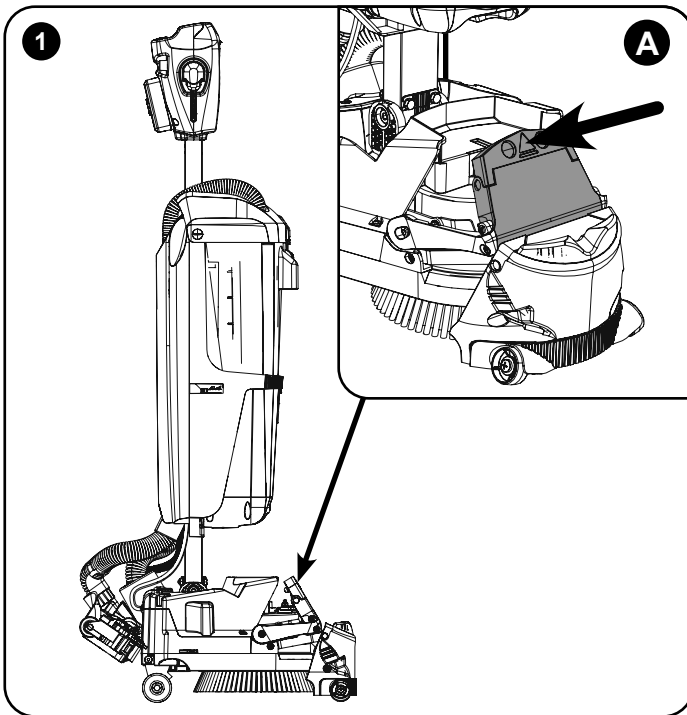

To lower the machine deck to the ground - Hold machine handle. Use your foot to press parking mechanism (B). (By closing the parking mechanism, the front and rear support wheels retract).

To lower floor tool - Press down onto the toe cap area behind the hose (B)

Pull the small lever on the right-hand side of the handle upwards (C) and then pull the handle backwards (4).

To raise the floor-tool (for over-scrubbing without picking up water) use the toecap locations to the rear of the floor-tool (D or E).

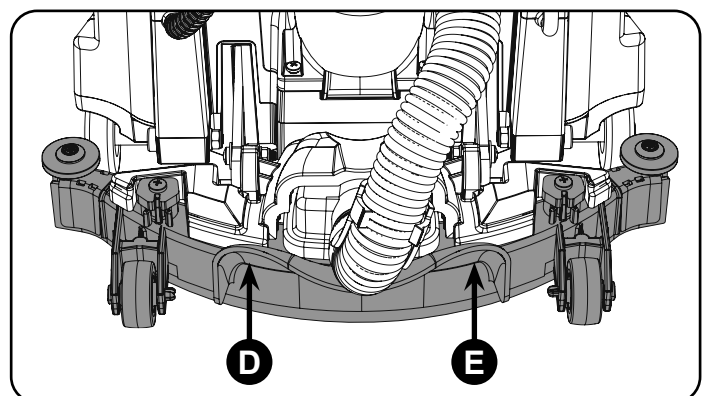

**KEEP HANDS AWAY FROM
PARKING MECHANISM**



Machine Handle Operation

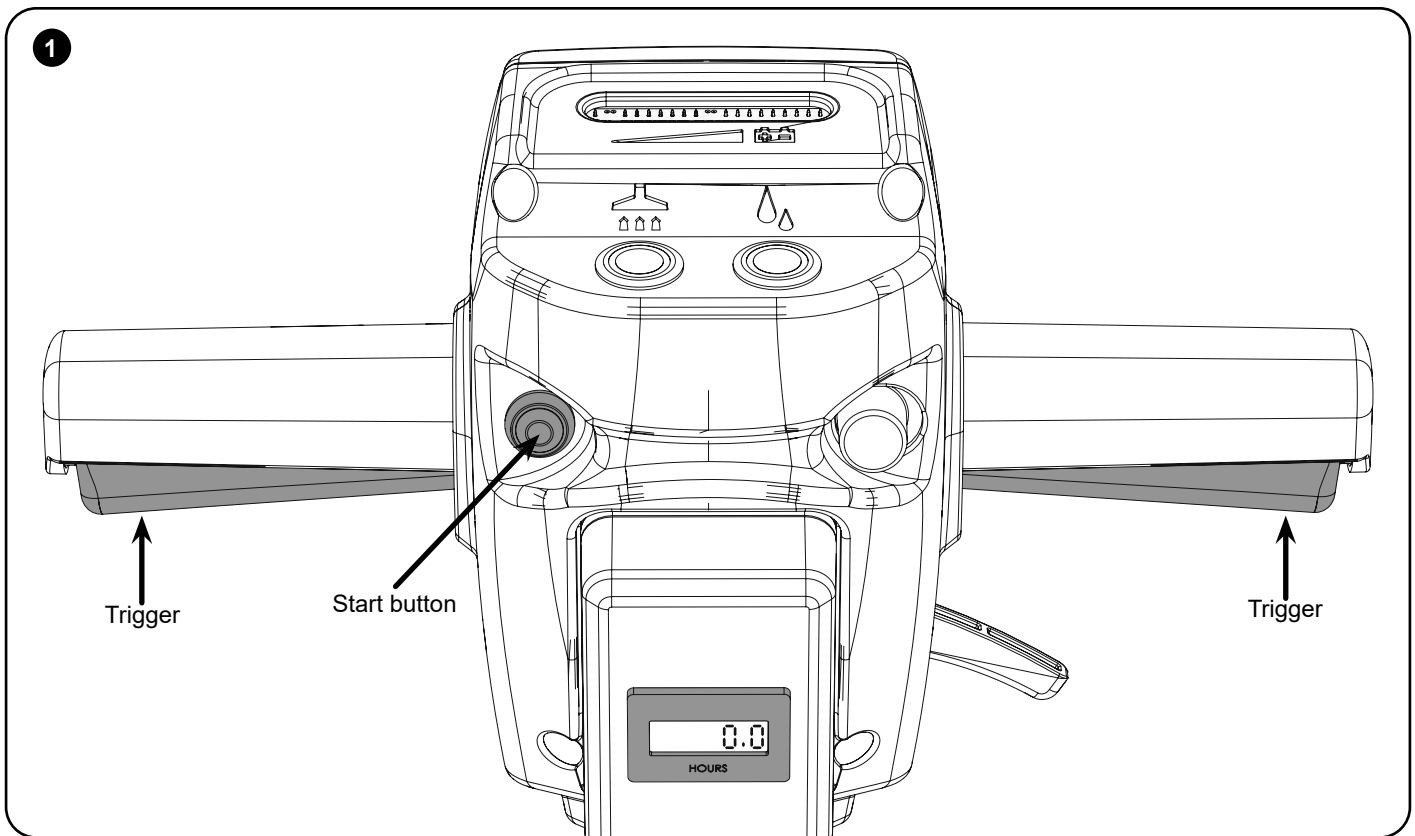

To start the machine, pull one or both triggers in and press the start button, this will start the brushes spinning and the battery power indicator will illuminate to show the power level. This will also cause the hours meter to start counting up, recording machine usage, indicated by the flashing dot on the display. The hours meter display will always show the total hours even if the battery is removed from the product.

HOURS METER ONLY RECORDS WHEN BRUSHES ARE SPINNING

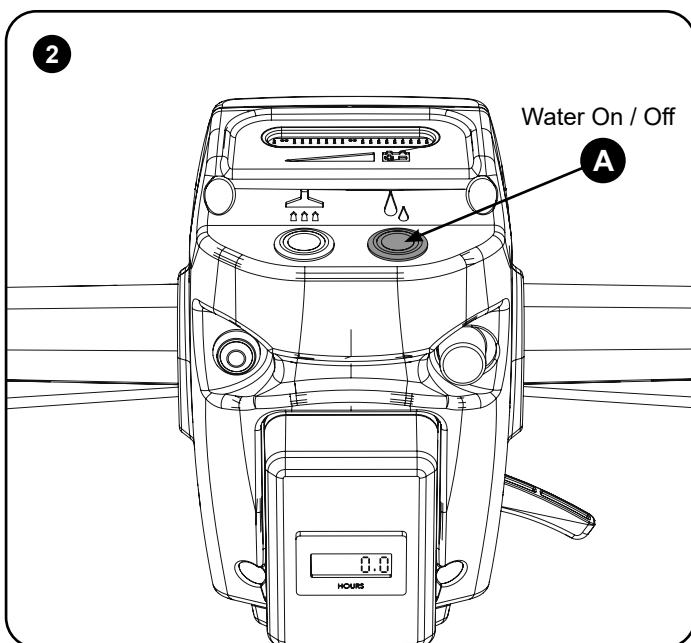

With either trigger pulled in press the water on button, this lights up blue to indicate it is on.

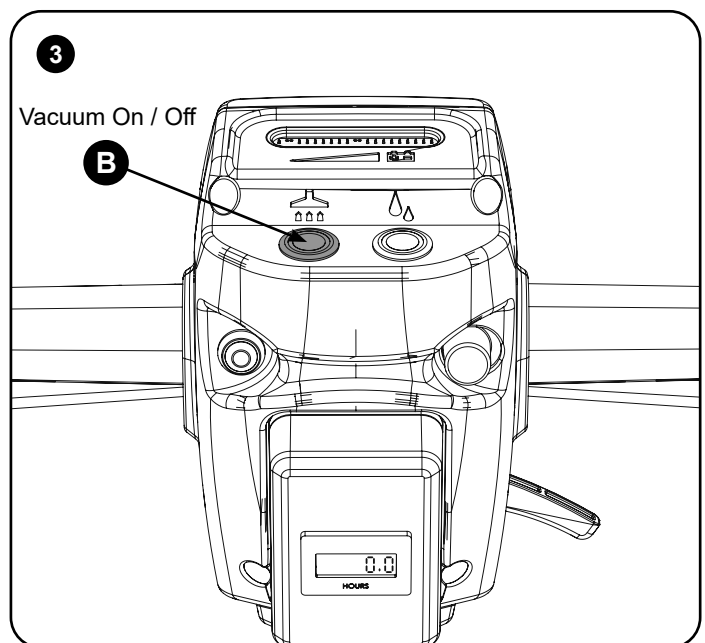

Press the vacuum on button, this lights up blue to indicate it is on and the vacuum starts. You are now ready to start cleaning.

Storage and Transport

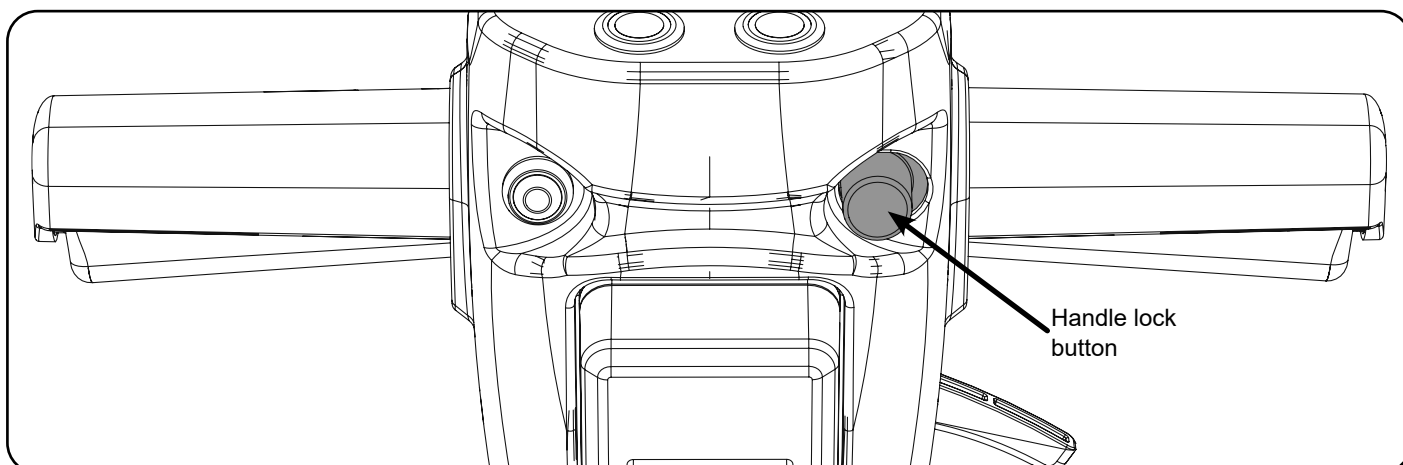

Make sure the handle is in the upright position and locked in place, push the handle lock button and locate handle in correct position.



KEEP HANDS AWAY FROM PARKING MECHANISM

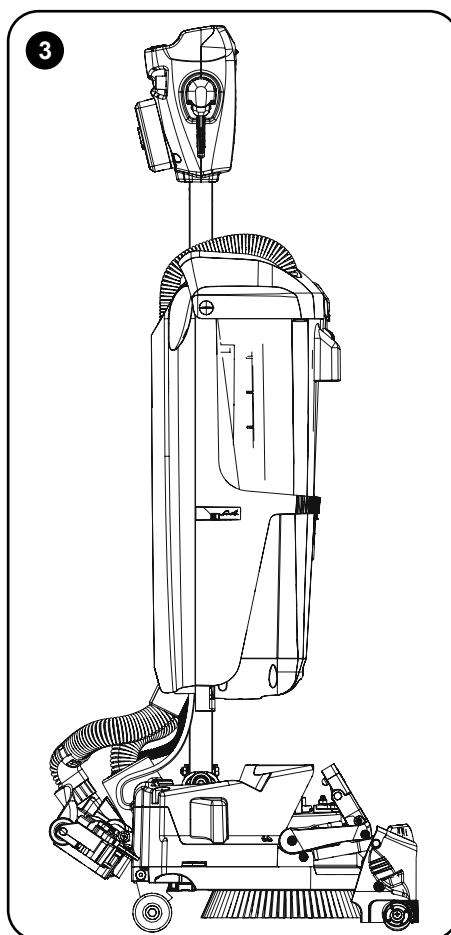
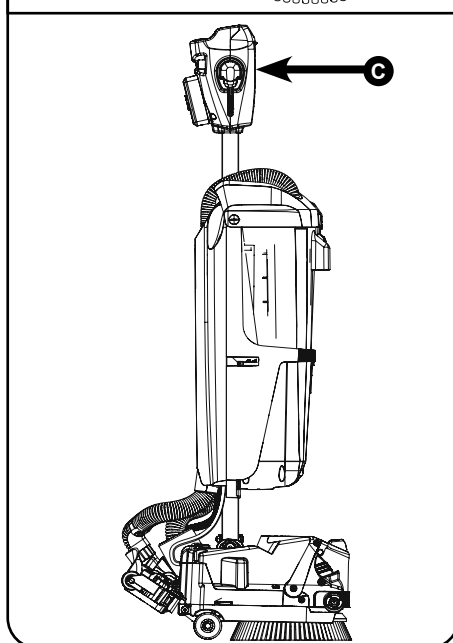
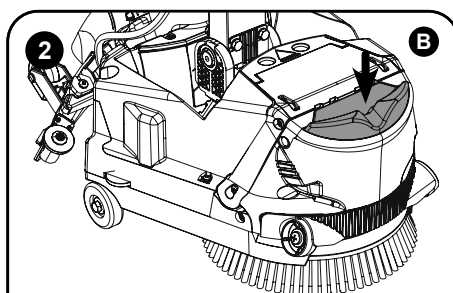
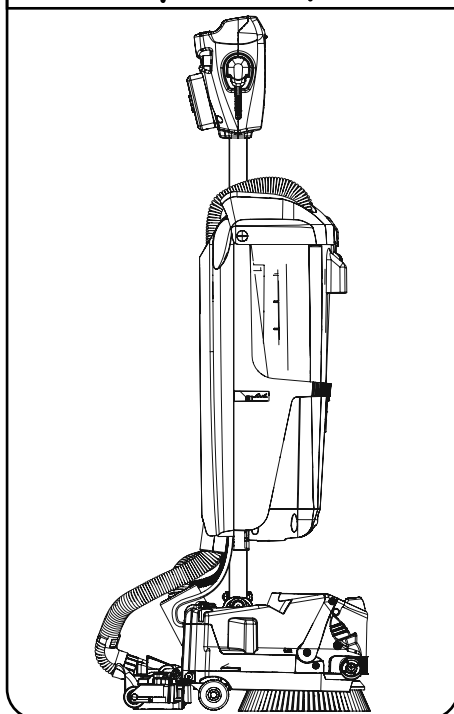
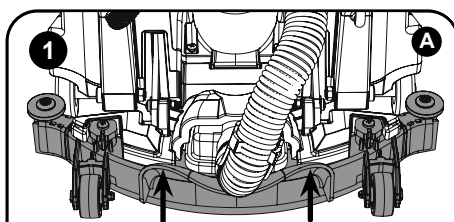

To raise the floor tool, use the toecap locations to the rear of the floor tool and lift up (A). To raise the machine deck off the ground. Hold onto handle. With your foot, press down on the front of the parking mechanism (B) while tipping the machine backwards (C) until the storage wheels click into position and the front support wheels extend (3).



**MAKE SURE THE HANDLE IS LOCKED IN THE UPRIGHT POSITION
BEFORE LETTING GO OF THE HANDLE.**



Regular Maintenance

Separator removal and cleaning

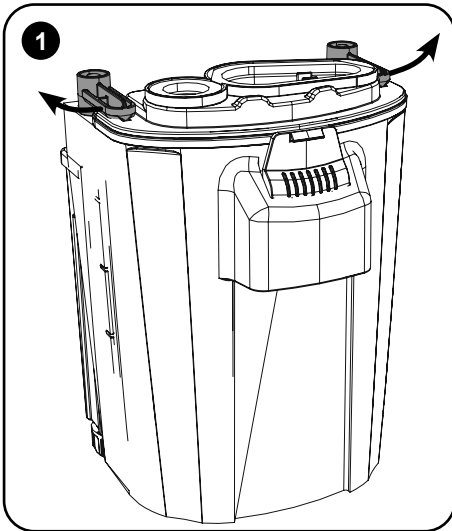

Twist separator locks to sides to unlock separator from tank.

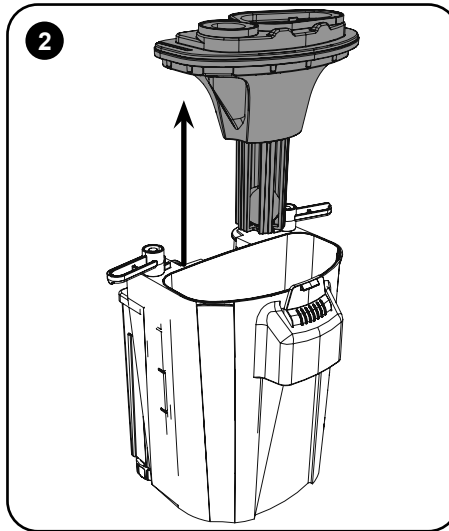

Lift the separator away from the tank.

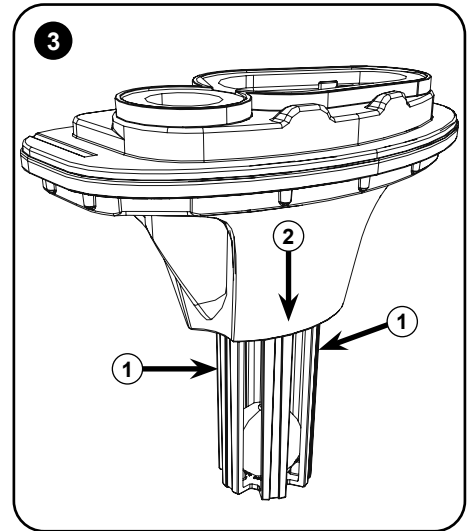

Gently squeeze sides of float valve cage (1) and slide down baffle (2).

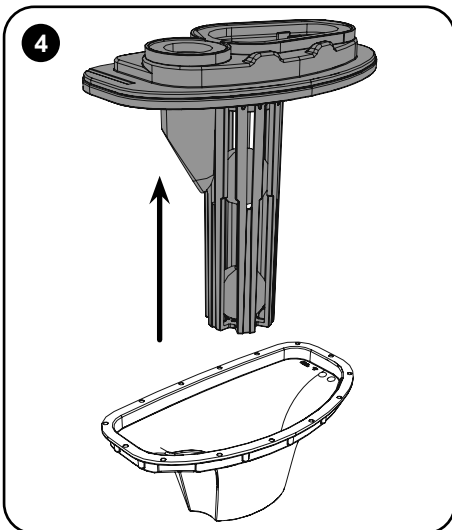

Fully remove separator from baffle.

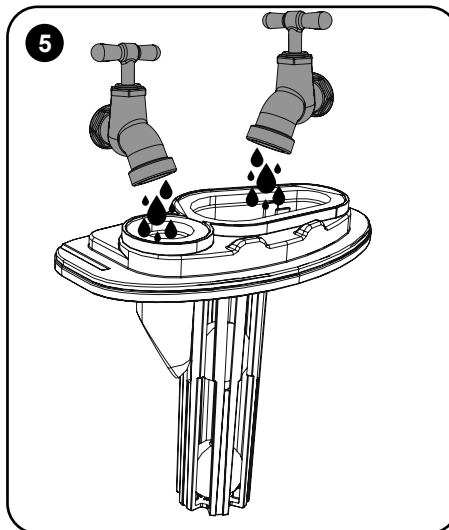

Once the separator has been removed, wash thoroughly under a tap making sure to run water through the tubes and to clean the grid filter.

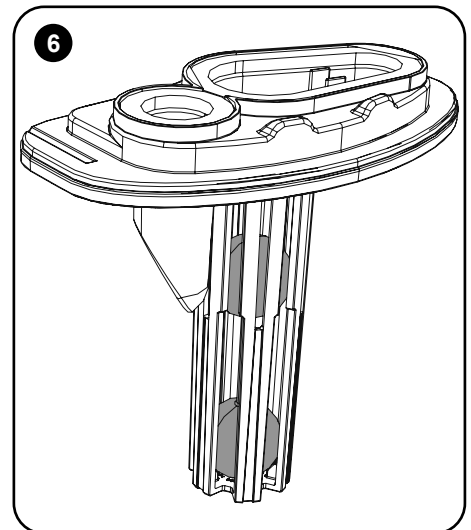

After cleaning separator, check float valve moves freely and is clean of any debris.

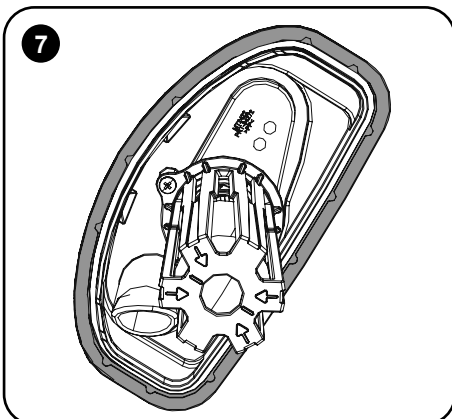

Once clean thoroughly check the rubber seal for any damage or cracks. If any damage or cracks are found on the rubber seal replace the separator. Failure to replace could cause loss in suction and machine performance.

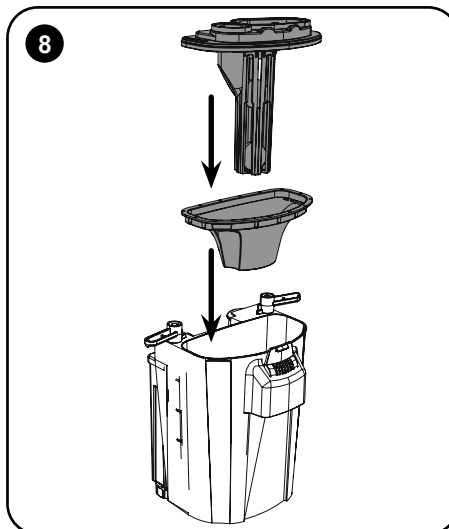

Refit the separator and baffle to the water tank.

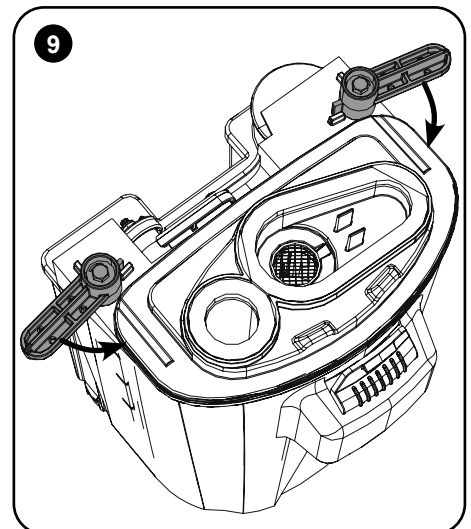

Twist separator locks to lock separator in place.

Regular Maintenance

Clean water tank outlets

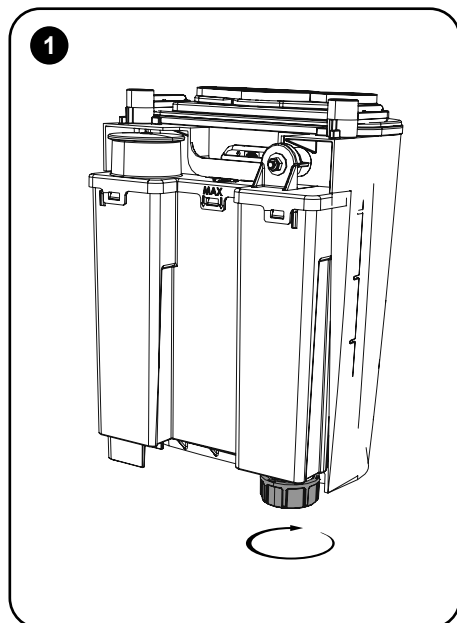

Make sure the clean water tank is empty. Unscrew the clean water outlet

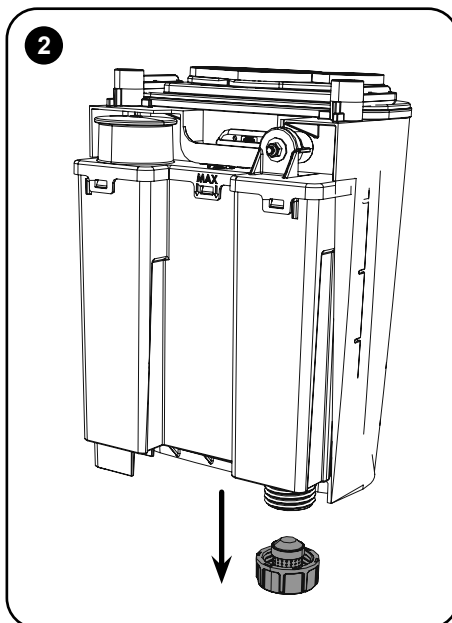

Remove the clean water outlet from the clean water tank.

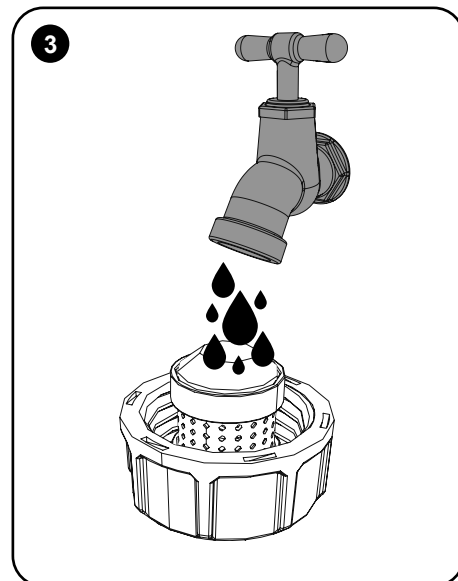

Wash the clean water outlet thoroughly under a tap, make sure the filter is clean with no blockages. Check for any damage (if any damage is found replace the clean water outlet).

Emptying tanks

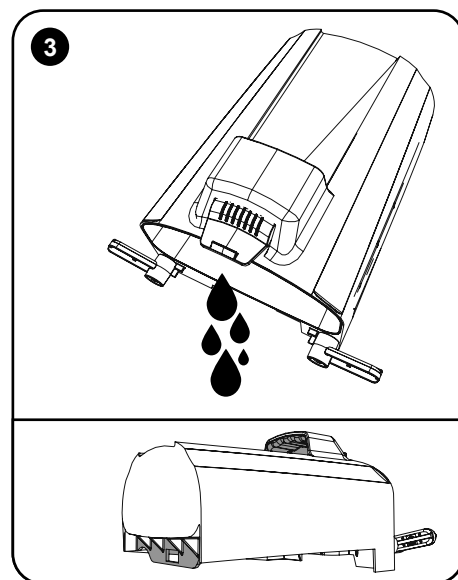
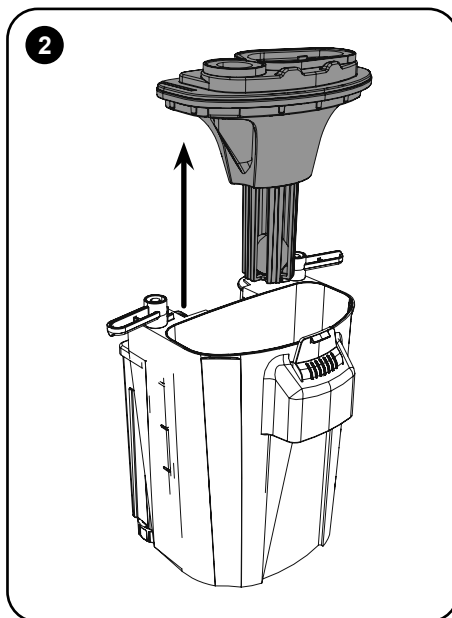
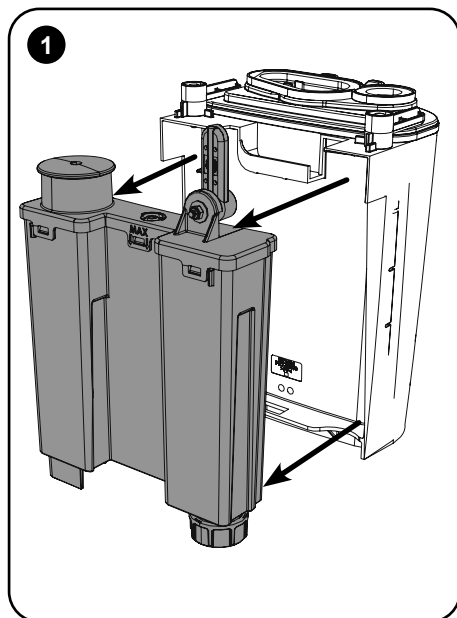

When finished using the machine it is good practise to empty and clean the tanks of the machine.

To do this firstly remove the tank assembly from the machine (see set up),

1. Remove the clean water tank from the main tank body and empty.

2. Remove the separator from the tank.

3. Pick up the tank, use the front handle and base as handles, tip the contents into a suitable drain, rinse the tanks and repeat the emptying process. Refit the clean water tank and separator and place back onto the machine.



NOTE: IF THE MACHINE IS TO BE LEFT FOR LONG PERIODS BETWEEN USE, ENSURE THE CLEAN WATER TANK IS EMPTIED.



Regular Maintenance

Fluid Trap Cleaning

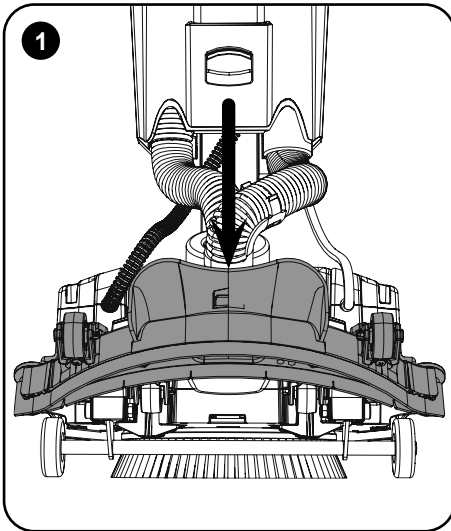

Lower floor tool by pressing down on toe cap area behind hose.

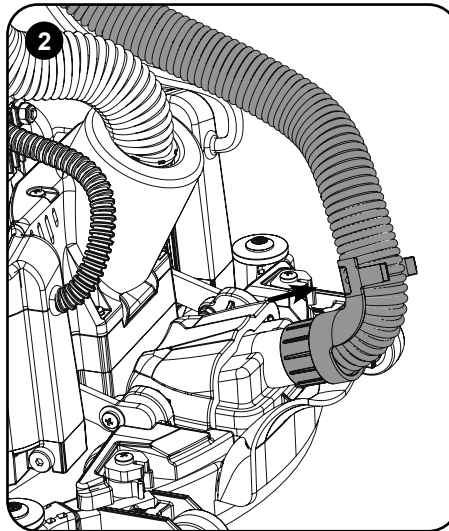

Remove hose from floor tool.

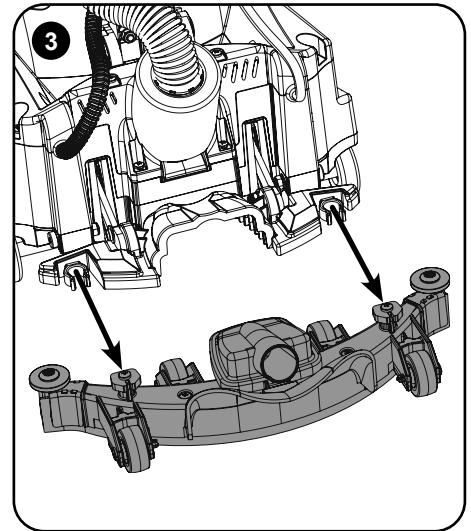

Pull the floor tool away from the machine.

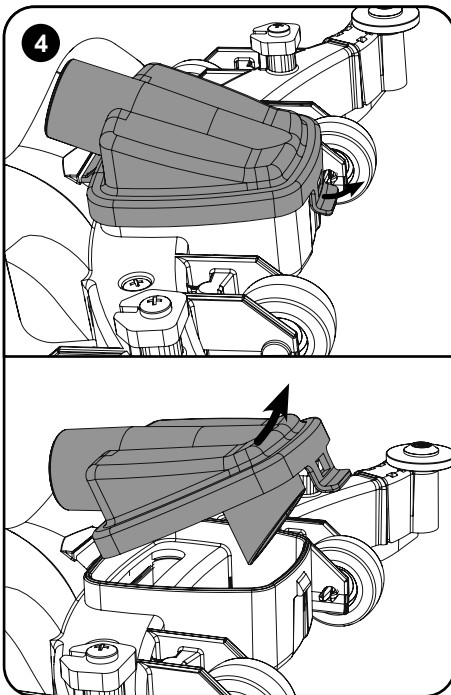

Unclip front of fluid trap while lifting trap from floor tool.

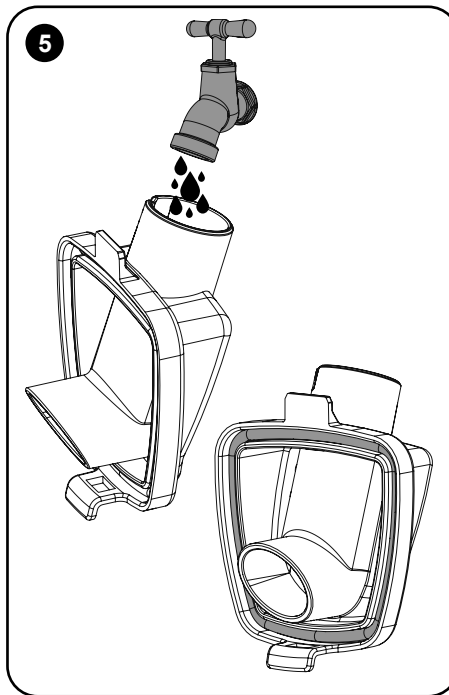

Wash thoroughly and remove any debris.
When cleaning check rubber seal for any cracks or damage.

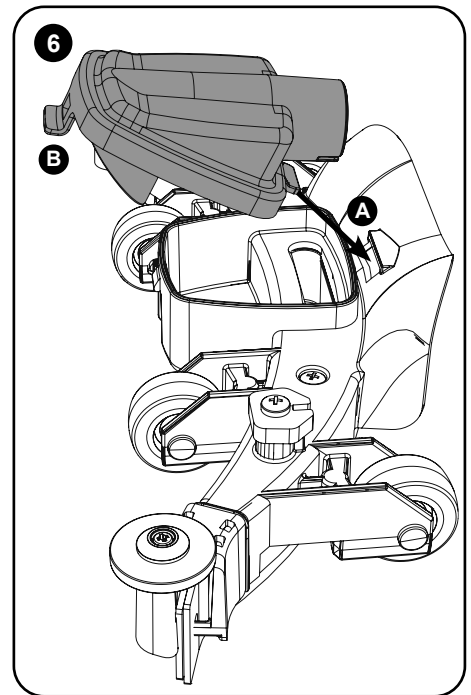

Refit by locating lug in floor tool (A) and lowering fluid trap until front clip clicks (B).

Daily
Keep the machine clean.
Ensure brushes / pads / squeegee / filters are in good condition.
Check for any worn or damaged parts and replace immediately.
Drain and rinse dirty water tank after every use.

Weekly – as daily and –
Check brush / pad and deck skirt, wipe and rinse.
Check floor tool blades for wear and wipe clean.
Clean separator assembly including filter and check condition of seal.
Flush out system with clean water and clean filters.

Maintenance

Changing the Floor Tool Blades



ALWAYS MAKE SURE THAT THE MACHINE IS SWITCHED OFF AND THE BATTERY IS REMOVED PRIOR TO ANY MAINTENANCE.

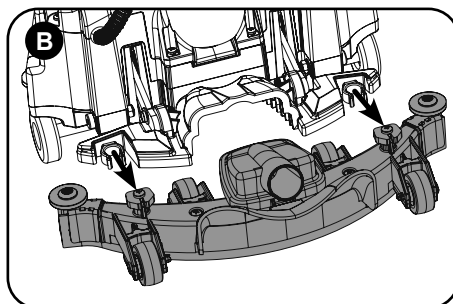
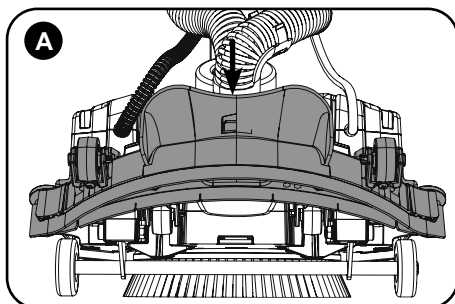

To change the floor tool, firstly lower the floor tool by pressing down on the toe cap located behind the hose (A).

Pull the floor tool away from the machine (B).

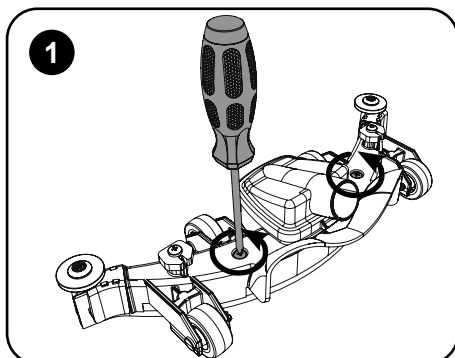

Unscrew the two screws securing the blade holder.

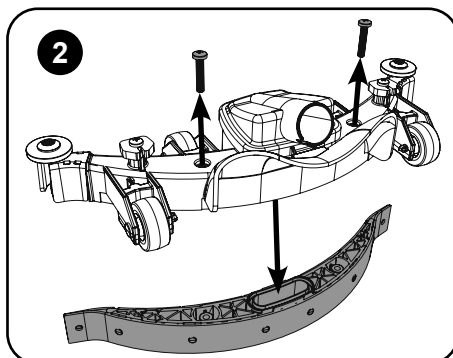

Remove the screws and blade holder.

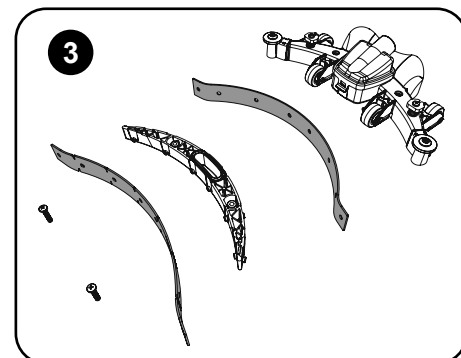

Replace the Squeegee blades using replacement blade set (3), fitting the blades on to the moulded location lugs.

Refitting the floor tool blades

Floor Tool Overview

1. Screws x 2
2. Front blade (Slotted / Reversible)
3. Blade carrier
4. Rear blade
5. Floor tool main body

NOTE: The blades are designed to be reversible and rotated giving 4 usable surfaces (front, back, top and bottom, thus extending their useful working life).

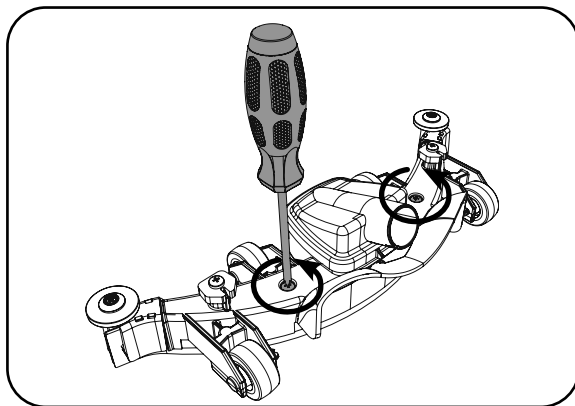
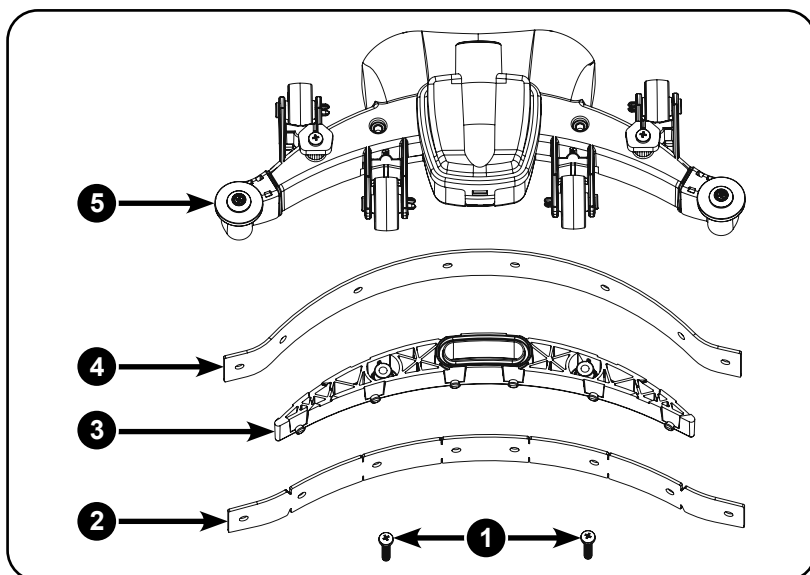

Refit the blade holder, retain using the two screws. Make sure the slotted blade goes to the front of the floor tool.

Make sure the end holes on both squeegee blades are positioned correctly on 'T' shaped clip mouldings (A)

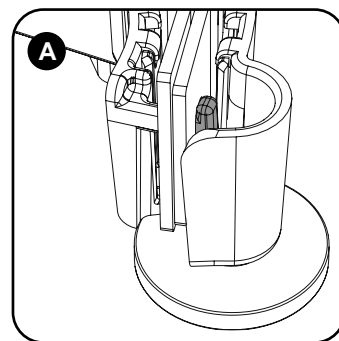

Battery Removal and Charging

Removing the battery

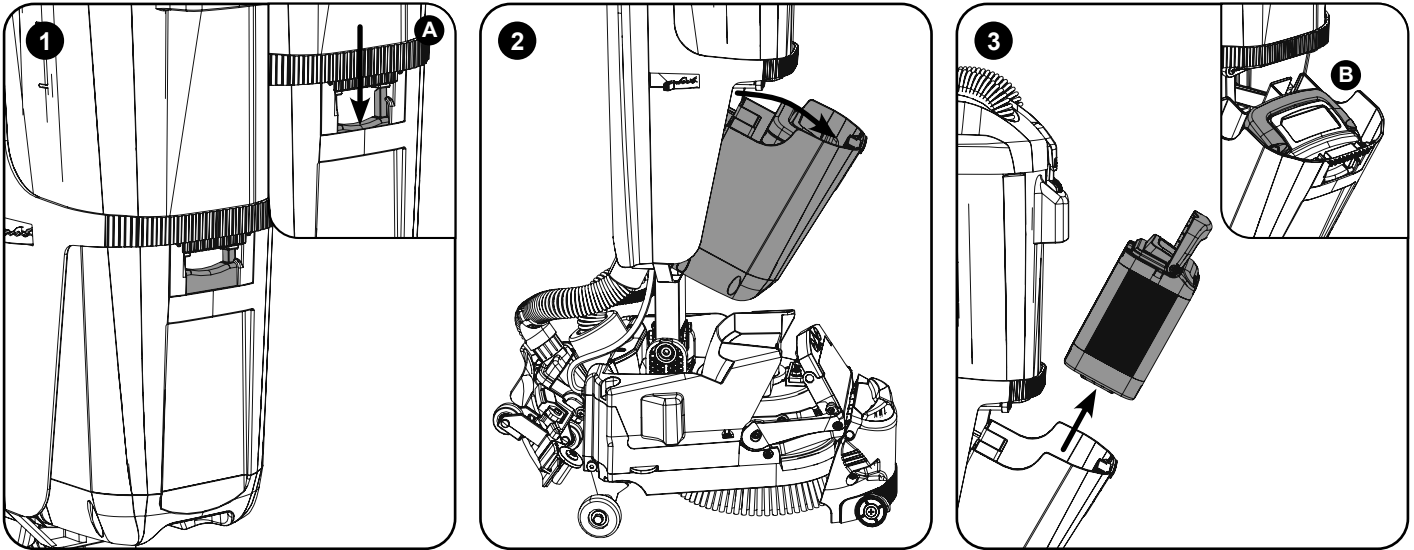

While holding down the battery compartment latch (A), tip battery compartment forward.
Lift the battery using the battery handle.

The battery can then be lifted from the machine for storage or charging using the handle on the battery (B).

For information relating to the operation and charging of your battery please refer to the battery and charger original operating instructions.

Schematic Diagram

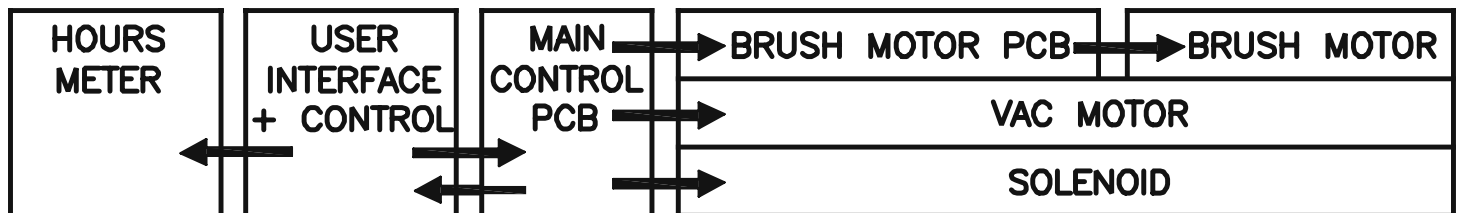

Notes

Specifications

Brush / Pad Weight (in cleaning mode)		Brush / Pad Pressure (in cleaning mode)		Cleaning Area	Brush Motor Power	Brush Speed	Brush / Pad Width
7.7 kg		Brush 24.4 g/cm ² Pad 23.4 g/cm ²		660 m ² /Hour @ 3 km/h	120W	140 rpm	1 x 220mm
Vac Motor Max Power	Clean Tank Capacity	Waste Tank Capacity	Water Ingress	Gross Weight (With liquid & battery)	Nett Weight (No liquid & No battery)	Rating	
36v 100W	1 L	1.5 L	IPX3	21.9 kg	17 kg	220W	
*Run Time (Battery life)	*Recharge Time	Dimensions			Hand Arm Vibration	Sound Pressure	
105 Min	*1 Hour (80%) *2 Hours (100%)	Width = 380 mm Length = 530 mm Height = 1160 mm			≤ 2.5 m/s ²	LpA ≤ 70 dB(A)	
*Run and Recharge times may vary dependent on ambient temperature.							

Trouble Shooting

PROBLEM	CAUSE	SOLUTION
Machine will not operate	Battery not connected Low battery charge	Connect battery (page 7) Charge battery (page 14)
Vacuum will not operate	Vacuum not turned on	Turn on vacuum (page 9)
Poor water pick-up	Waste-water tank full Clogged / blocked squeegee hose Loose hose connections Separator filter clogged / blocked Poor separator seal Fluid trap clogged or poorly fitted Damaged separator seal Damaged / split vacuum hose Damaged floor-tool blades Low battery charge	Empty waste-water tank (page 12) Remove and clean (page 5) Push tight connections (page 5) Clean (page 11) Clean and refit (page 11) Clean and refit (page 13) Renew (contact service dept) Renew (contact service dept) Renew (contact service dept) Recharge battery - see battery charger manual
No brush / scrub function	No brushes fitted Brush overloaded	Check and fit (page 5) Reset the machine and decrease the brush load
Little or no water flow	Clean-water tank empty Incorrect water flow setting Blocked clean water tank outlet	Fill clean-water tank (page 6) Adjust fluid control lever (page 7) Remove and clean (page 12)

Failure to rectify the problem or in the event of a breakdown contact your Numatic dealer or Numatic Technical helpline +44 (0)1460 269268

About the Machine

Rating Label	
1	Company Name & Address
2	Machine Description
3	Battery Voltage
4	Noise Emission
5	Hand Arm Vibration
6	Weight (ready to use)
7	Ingress Protection Rating
8	Gradient symbol
9	EU Importers info
10	Battery part number
11	Machine QR code
12	Approvals Mark
13	WEEE symbol
14	Part Number
15	Machine yr/wk Serial number
16	Numatic Support

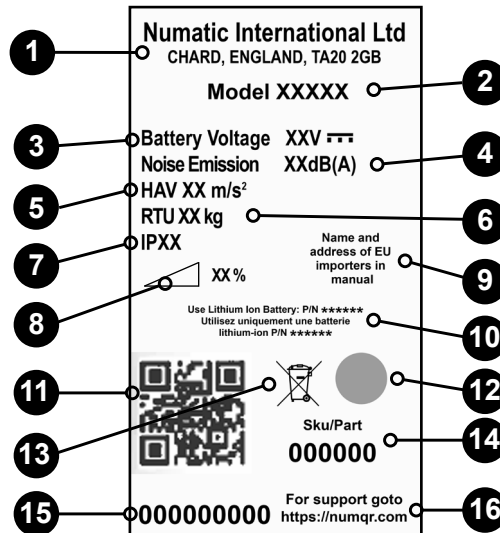

WEEE (Waste, Electrical and Electronic Equipment)

Scrubber dryer Accessories and packaging should be sorted for environmentally-friendly recycling.

Only for EU countries.

Do not dispose of scrubber-dryer into household waste.

According to the European Directive 2012/19/EU on waste electrical electronic equipment and its incorporation into national law.

Scrubber-dryers that are no longer suitable for use must be separated, collected and sent for recovery in an environmentally-friendly manner.

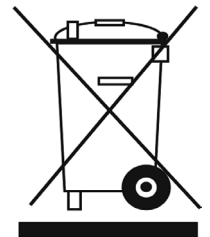

PPE (Personal protective equipment) that may be required for certain operations.

Ear Protection	Safety Footwear	Head Protection	Safety Gloves	
Dust / Allergens Protection	Eye Protection	Protective Clothing	Hi-Vis Jacket	Caution Wet Floor Sign

NOTE: A risk assessment should be conducted to determine which PPE should be worn.

Safety Critical Component:

Charging Leads: HO5VV-F x 0.75mm² x 3 CORE
Battery Charger: 100 - 240 Volt

*In the event of a breakdown contact
your Numatic dealer or the
**Numatic Technical
helpline +44 (0)1460 269268***

Information for Scrubber Dryer

READ MANUAL BEFORE USE



COMPONENT	INTERVAL	INSPECT FOR
Battery Charger Lead	DAILY	Scuffing, cracks, splits, conductors showing
Brushes	DAILY	Bristle damage, wear, drive collar wear
Squeegee Blade	BEFORE EACH USE	Wear, cracks, splits
Filters	BEFORE EACH USE	Clogging and debris retention
Tanks	AFTER EACH USE	Rinse dirty water tank after use



As with all electrical equipment care and attention must be exercised at all times during its use, in addition to ensuring that routine and preventative maintenance is carried out periodically in order to ensure its safe operation. Operators shall be adequately instructed on the use of these machines.

Failure to carry out maintenance as necessary, including the replacement of parts to the correct standard could render this equipment unsafe and the manufacturer can accept no responsibility or liability in this respect. When ordering spare parts always quote the Model Number / Serial Number specified on the Rating Plate. Do not use for cleaning purposes on surfaces having a gradient exceeding that marked on the machine.

This machine is not intended for use by persons (including children) with reduced physical, sensory or mental capabilities, or lack of experience and knowledge. Children should be supervised to ensure that they do not play with the appliance.

Only use brushes provided with the appliance or those specified in the instruction manual.

The use of other brushes may impair safety.

A full range of brushes and accessories are available for this product.

Only use brushes or pads which are suitable for the correct operation of the machine for the specific task being performed.

It is essential that this equipment is correctly assembled and operated in accordance with current safety regulations.

When using the equipment always ensure that all necessary precautions are taken to guarantee the safety of the operator and any other persons who may be affected.

Wear non slip footwear when scrubbing. Use a respiratory mask in dusty environments.

When cleaning, servicing or maintaining the machine, replacing parts or converting to another function the battery should be removed.

Machines left unattended shall be secured against unintentional movement.

When detergents or other liquids are used, read the manufacturer's instructions.



This machine is not suitable for picking-up hazardous dust.
This machine is not to be stored outdoors or in wet conditions.
This machine is for indoor use only.

NOTES: This machine is intended for commercial use, for example in hotels, schools, hospitals, factories, shops, offices and rental businesses. This product meets the requirements of IEC 60335-2-72



DO

- Ensure only competent persons unpack / assemble the machine.
- Keep your machine clean.
- Keep your brushes in good condition.
- Replace any worn or damaged parts immediately.
- Ensure that the work area is clear of obstructions and / or people.
- Ensure that the working area is well illuminated.
- Pre-sweep the area to be cleaned.



DON'T

- Use steam cleaners or pressure washers to clean the machine or use in the rain.
- Allow any inexperienced repairs. Call the experts.
- Allow the machine to be used by inexperienced or unauthorised operators or without appropriate training.
- Use the machine without the solution tanks properly positioned on the machine, as shown in the instructions.
- Expect the machine to provide trouble-free, reliable operation unless maintained correctly.
- Allow water solutions to ingress to the battery.
- Lift or pull the machine by any of the operating triggers, use the main handle.

Numatic Lithium-ion Rechargeable Battery

36V | 8400mAh | 300Wh | 2.06KG | 10INR19/65-3



It is important that you observe the following information and warnings!

Emergency Contact Information		
Address:	CBAK BATTERY HEADQUARTERS Shenzhen BAK ENERGY Co. LTD, 2603A BAK Tech Bldg, 9th Keyan Rd, Hi-tech Park, Nanshan Dist, Shenzhen City, China	NUMATIC INTERNATIONAL LTD Millfield Road, Chard, Somerset, TA20 2GB, UK
Tel:	0086-755-83283710	0044-146-068600
Fax	0086-755-8328649	0044-146-068458
www.numatic.com www.numatic.de www.numatic.ch www.numatic.fr www.numatic.nl www.numatic.co.za www.numatic.pt www.numatic.es www.numatic.it www.numatic.dk		

1. DEFECTIVE BATTERIES

1. If a customer wishes to return a battery to a supplier, then collection of the battery must be arranged by the supplier; however, **Faulty batteries must not be returned through the postal system or by courier.**
2. If on return to a supplier, OR at a customer base, a suspected defective battery shows any signs of impact damage, distortion, blistering, loose parts, liquid ingress or leakage then on no account should it be offered for condition checking. It must be considered defective and the procedures described from item 9 below should be followed.
3. If, on return to a supplier, OR at a customer base, a suspected defective battery, that shows No signs of impact damage, distortion, blistering, loose parts, liquid ingress or leakage, may be offered for condition checking with an appropriate battery condition checking device operated by a competent person.
4. If battery is subjected to any liquid ingress users should put the pack upright immediately, with the terminal face downwards.
5. If checking shows the battery to be defective then the procedures described from item 9 below should be followed.
6. If on checking the battery is found to be operational then a single recharge cycle under observation can be attempted with the appropriate Numatic charger.
7. If the battery recharges correctly on this single recharge cycle then it can be deemed a good battery.
8. If the battery fails to recharge correctly on this single recharge cycle then it must be deemed a defective battery and the procedures described from item 9 below should be followed. **On no account must any further attempt to recharge be made. A defective battery should not be stored inside buildings on any account.**
9. The defective battery should be discharged by placing it in a container of salt water located in a well- ventilated area. This container should contain 25 litres minimum of saline water at a concentration of 15g common salt / litre of water. The container should have a closed locked lid but should not be sealed. The battery should be left fully immersed in the water to a depth of at least 100mm for at least 2 weeks. The water should be disposed of as hazardous waste when the discharge is complete.
10. The defective discharged battery can then be stored in a locked battery waste container which should be plastic or plastic lined and placed away from buildings and clearly signed as a defective battery container with appropriate warnings.
11. The batteries should then be sent for waste disposal according with your country's waste regulations.
12. Exhausted batteries are to be removed from the appliance and safely disposed of.

An example of a waste battery storage bin well away from buildings.

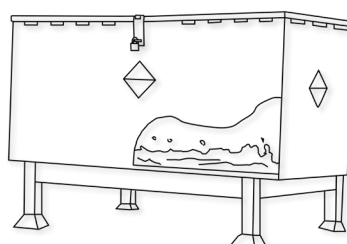

2. HANDLING AND STORAGE

DANGER!

Improper handling can lead to an explosion or ignite a fire!
Store batteries out of reach of children.

- Insert the battery in the appliance only when it is in use.
- Always remove the battery from the appliance for transport and when it is not in use.
- Storage temperature range: -10°C~55°C.
- Temperatures must not exceed 55°C.
- Relative humidity range: 45 to 80%.
- Optimum preservation of functionality: 15°C~25°C.

WARNING:

- Do not open the battery, disassemble it or allow it to fall from a substantial height.
- Protect the battery against short-circuiting – danger of explosion!
- Protect the battery against rain, do not immerse in liquids especially flammable liquids – danger of short-circuiting potential risk of fire or explosion. Follow defective battery disposal safety procedure. Insure the product is moved away from any combustible source.
- Protect the battery against direct sunlight, heat and fire.
- Do not incinerate the battery – danger of explosion!
- Do not use defective or deformed batteries.
- Use only original NUMATIC chargers to charge the battery.

STORAGE:

- If the appliance is to be stored unused for a long period, the batteries should be removed.
- Good batteries should be stored in a protected area away from sources of direct heat and sunlight and should be kept dry.
- The temperature should not exceed 55°C but preferably not be above 25°C to maintain good battery performance.
- Storage area should be of low humidity, non dusty and a non corrosive atmosphere.

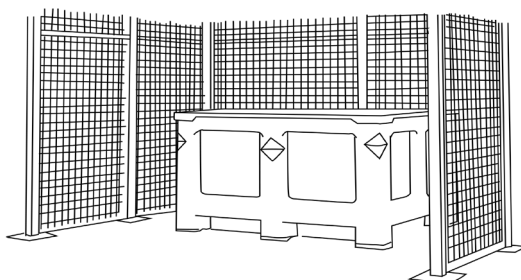

- An example of a well protected area with a cage to protect against accidental impact damage and with the batteries stored in a protective container to protect from heat, impact and accidental spillage of liquids.
- Care when handling / moving with forklift trucks or pallet trucks is needed at all times to avoid any physical damage to the batteries.
- If a good battery at any time is mishandled or subjected to any conditions that may damage it, as described in the battery instruction manual supplied, it must then be considered as defective and procedures followed from Item 1 of this document overleaf.

3. HAZARDS IDENTIFICATION

- Electrolyte may escape from damaged batteries. Avoid contact.
- Contact can cause skin irritation, burns and chemical burns.
- If liquid comes into contact with eyes, seek medical attention.
- Avoid inhaling any vapours formed or released – caustic.

4. FIRST AID MEASURES

In the event of contact with released electrolyte or electrolyte vapours:

- Eye contact – flush eyes for at least 15 minutes with plenty of clean water without rubbing and seek medical attention.
- Skin contact – wash affected areas of skin with plenty of water and soap; if irritation persists, seek medical attention.
- Inhalation – provide fresh air or administer oxygen immediately and seek medical attention.
- Ingestion – if electrolyte has been ingested, seek medical attention immediately.

Information for physicians:

- Contains caustic alkaline electrolytes in cells with lithium oxide, nickel oxide and cobalt/lithium manganese oxide cathodes – NO LITHIUM METAL OR LITHIUM ALLOYS.

5. FIRE FIGHTING MEASURES

- In case of fire – Keep clear of vapours and gases generated, take wind direction into consideration. If possible without danger, remove batteries from the vicinity of the fire. In principle, cooling or extinguishing with water is possible, but should only be done by trained personnel with sufficiently large quantities of water.
- If the hazard situation is unclear, extinguish only with ABC powder extinguishers (Class D extinguishers for fires involving metals are especially suitable).
- Fire fighters should only approach the fire wearing protective clothing and self-contained breathing apparatus.
- Once the fire has been extinguished, as a rule, the area should be monitored (fire watch) and cleaned up by trained and appropriately equipped personnel; fire residue should be contained and disposed of properly.

6. EXPOSURE CONTROLS, PERSONAL PROTECTION

Respiratory Protection:

- In case of battery venting, providing as much ventilation as possible. Avoid confined areas with venting batteries.
- Respiratory Protection is not necessary under conditions of normal use.

Ventilation:

- Not necessary under conditions of normal use.
- Protective Gloves:
- Not necessary under conditions of normal use.

Other Protective Clothing or Equipment:

- Not necessary under conditions of normal use.
- Personal Protection is recommended for venting batteries: Respiratory Protection, Protective Gloves, Protective Clothing and safety glass with side shields.

7. ACCIDENTAL RELEASE

Disposal – Wear protective gear, wipe up with absorbent textile and dispose of as hazardous waste at collection points for hazardous waste according to national regulations.

8. DO

- Use NUMATIC batteries only with NUMATIC appliances and charge them only using NUMATIC chargers.
- Charge battery before use.
- Store the battery out of the reach of children.
- Secure the appliance against unintentional start up – remove the battery from the appliance before transporting or storing the appliance.
- Protect from rain and liquid ingress
- Protect from direct sunlight, heat, and open flames.
- Be aware of the risk of terminals of the battery-operated appliance or battery being short circuited by metal objects.
- Follow the disposal advice of the manufacturer and any internal waste management guidance.
- Use and store the battery with-in temperature range (as shown in Temperature Range Table).

Warning: Use only with Numatic battery charger. The battery included in this product must only be charged by the Numatic Charger and docking system supplied with the product and in NO circumstances should an alternative non Numatic charger be used as there is risk severe damage and fire could result.

Note* "If batteries are subjected to temperatures beyond normal operating limits automatic shutdown will occur. Under these conditions allow the batteries to acclimatise at room temperature (18°C – 22°C) for several hours to allow the battery to wake up".

Temperature Range Table	
CHARGING	5°C~35°C
DISCHARGING	5°C~35°C
STORAGE OPTIMUM	15°C~25°C
STORAGE LIMIT	-10°C~55°C

9. DO NOT

- Throw battery into fire – risk of explosion!
- Charge or use a defective, damaged or deformed battery including batteries subjected to liquid ingress.
- Open, damage or drop the battery.
- Expose the battery to microwaves or high pressure.
- Immerse in fluids, especially flammable liquids.
- Insert objects in the battery's cooling slots.
- Bridge (short circuit) the battery terminals with metallic objects since this may damage the battery.
- Use metal containers for transporting batteries.
- Expose the appliance or battery to excessive temperatures.
- Expose the batteries to high temperatures including direct sunlight.
- Crush, break open or physically abuse the batteries or the equipment that contains them.
- Use modified or damaged batteries.

10. DISTRIBUTOR TAKE-BACK / DISPOSAL



- On the basis of Battery Directive, the manufacturers take responsibility for financing collection, treatment and recycling of batteries used in devices. To this end, batteries must be handed over for disposal to the collection systems established for this under national law. Disposal of batteries together with household waste is prohibited; batteries must be collected separately according to type.
- Return the battery free of charge to your NUMATIC servicing dealer for disposal or hand it over to an appropriate public collection point.

11. CHARGING BATTERIES

- The charger is intended for use only on flat surfaces, place horizontally on floor or work surface. The charger is intended for use with the detachable power cord supplied, the power unit is capable of operating at different voltages without user adjustment. If the charger is damaged or does not charge anymore, please return to service centre.

Charging Procedure:

- Rechargeable batteries are to be removed from the appliance before being charged.
- Ensure the battery is fully inserted into the charger.
- Fit the mains power cord to charger and suitable power supply.

Please Note: If the battery is above its optimum charging temperature (due to ambient temperature or it if was recently discharged) the charger LED will illuminate on/off RED for a maximum of 40 minutes whilst the battery temperature falls to an acceptable level for charging to begin.

- The LED should show RED to indicate charging.
- Once fully charged the LED will show GREEN.
- If power is supplied to the charger with no battery fitted the LED will show GREEN to indicate STAND-BY status.

CAUTION!

- Protect the charger against moisture and store it in a dry place.
- Check the mains cord regularly for any sign of damage.
- Do not use damaged devices.
- If the mains cord of the charger is damaged, it must be replaced by an original NUMATIC INTERNATIONAL cord available from the manufacturer or service agent.

Battery Charger State of Charge Indicator (SoC)

No Battery Connected	Green Flashing Light
Charging	Red Light
80% Charged	Green Light
Error Condition / Battery Over Temperature	Red Flashing Light

12. WARRANTY

Lithium-Ion Battery Warranty

Warranty: Commercial Use

- Batteries are warranted (3 Year) providing all battery care rules are followed
- To claim warranty the following details must be supplied
 - Serial number of the machine (See page 16)
 - Battery date code
 - Date purchased
 - Proof of Purchase
 - Maintenance history and charging regime

Failure to use the correct Numatic charger will void your warranty.



ZP19006-01FYWW00001

Serial number
Week of production
Year of production

Spare Parts

Part No.	SPARES & ACCESSORIES	Part No.	SPARES & ACCESSORIES
911334	LITHIUM BATTERY CHARGER	912363	CHARGER CABLE (SOUTH AFRICAN)
912365	CHARGER CABLE (UK)	912360	CHARGER CABLE (AUSTRALIAN)
912361	CHARGER CABLE (EURO)	912362	CHARGER CABLE (NORTH AMERICAN)
912364	CHARGER CABLE (SWISS)		

UKCA Declaration of Conformity	
Manufacturer:	Numatic International Limited Chard Somerset TA20 2GB www.numatic.co.uk
Product:	NCC220
Description:	Floor Treatment - Walk Behind – Commercial - Battery
We, Numatic hereby declare under our sole responsibility, that the above-mentioned product(s) is/are in conformity with the following directives and standards.	

S.I. 2008: 1597	Supply of Machinery Regulations	EN60335-1:2012 + AC:2014 + A11:2014 + A13:2017 + A15:2021 EN60335-2-72:2012 EN62233:2008
-----------------	---------------------------------	--

S.I. 2016: 1091	EMC Regulations	EN55014-1:2017 + A11:2020 EN55014-2:1997 + A1:2001 + A2:2008
-----------------	-----------------	---

S.I. 2012: 3032	RoHS Regulations	
-----------------	------------------	--

Authorised Signatory: Mr. Matthew Coles

Position: Head of Technology

Numatic International Limited,
Chard,
Somerset, TA20 2GB, UK

Signed:  Date: 28th April 2025

EU, EC, EL, UE, ES: Declaration of Conformity Декларация о соответствии Megfelelőégi nyilatkozat Dichiarazione di conformità Atikties deklaracija Overensstemmelseklæring Declaración de conformidad Vastuudeklaratsioon Déclaration de conformité	Декларация за съответствие Декларация о соответствии Megfelelőégi nyilatkozat Dichiarazione di conformità Atikties deklaracija Overensstemmelseklæring Declaración de conformidad Vastuudeklaratsioon Déclaration de conformité	Declaracja zgodności Declaratie de conformitate Deklaracija o sootvetstvii Försäkran om överensstämmelse Izjava o skladnosti Vaatumustenmukaisuusvakuutus
Manufacturer: / Производител / Fabricant / Fabricante / Tootja / Fabricant / Производитель / Κατασκευαστής / Gyártó / Fabricante / Gamintojas / Fabrikant / Produzent / Fabricante / Producent / Prodútor / Производител / Tilveikare / Proizvajalec / Valmistaja: Product: / Produkt / Produkt / Produkt / Produkt, Toodeit, Product / Продукт / Προϊόν / Termék / Producto / Produkta / Artikel / Produkt / Productos / Produkt / Produ / Produ / Товар / Produkt / Izdelka / Tuote: Description: / Popis / Beschreibung / Beskrivelse / Descripción / Kirjeldus / La description / Описание / Περιγραφή / Leírás / Descrizione / Apibūdijimas / Omschrijving / Beskrivelse / Descrição / Opis / Descriere / Описание / Beskrivning / Opis / Kuvaus:	Numatic International Limited Chard Somerset TA20 2GB www.numatic.co.uk NCC220	Numatic International Limited Chard Somerset TA20 2GB www.numatic.co.uk NCC220
We, Numatic hereby declare under our sole responsibility, that the above-mentioned product(s) is/are in conformity with the following directives and standards.		
EN We, Numatic hereby declare under our sole responsibility, that the above-mentioned product(s) is/are in conformity with the following directives and standards.	БГ Ние, Numatic С настоящото декларираме на своя лична отговорност, че посочените по-горе продукти са в съответствие със следните директиви и стандарти.	PT Nós, a Numatic declaramos, sob nossa exclusiva responsabilidade, que o produto acima mencionado está em conformidade com as direttrizes e normas a seguir.
CS My, Numatic prohlašujeme na svou výlučnou odpovědnost, že výše uvedený výrobek je ve shodě s následujícími směrnici a normami.	EL Εγείς, Numatic δηλώνουμε με αποκλειστική μας ευθύνη, ότι το προαναφερθέν προϊόν συμμορφώκεται με τις ακόλουθες οδηγίες και πρότυπα.	PL My, Numatic Niniejszym oświadczamy z pełnią odpowiedzialności, że wyżej wymieniony produkt jest zgodny z następującymi dyrektywami i normami.
DE Wir, Numatic erklären in alleiniger Verantwortung, dass das oben genannte Produkt den folgenden Richtlinien und Normen entspricht.	HU Mi, Numatic kijelentjük, egyedül felelősséggel, hogy a fent említett termék megfelel az alábbi irányelveknek és szabványoknak	RO Noi, Numatic Prin prezenta declarăm pe propria răspundere, că produsul mai sus menționat este în conformitate cu următoarele standarde și directive.
DA Vi, Numatic erklærer hermed under eget ansvar at ovennævnte produkt(er) er i overensstemmelse med følgende direktiver og standarder.	IT Noi, Numatic dichiara sotto la propria responsabilità, che il prodotto di cui sopra è conforme alle seguenti direttive e norme.	RU Мы, Нифи́кс ови́м и́зъявля́ем под пу́ным одго́ворно́стью, да́ наведе́ннóй прои́зводо́й, я́е у́ складу́ са́ следе́щих ди́рективи́а и ста́ндарди́ама.
ES Nosotros, Numatic declaramos bajo nuestra única responsabilidad que el producto antes mencionado está en conformidad con las siguientes directivas y normas	LT Mes, "Numatic pareiškiu vienašikišios atsakomybės, kad pirmiau minėtas produktas atitinka šias direktyvas ir standartus	SV Vi Numatic förklarar härmed under eget ansvar att ovan nämnda produkt överensstämmer med följande direktiv och normer.
ET Meie, Numatic käsolevaga kinnitame ja kanname ainuühtlasi vastutust, et eespool nimetatud toode on kooskõlas järgmiste direktiivide ja	NL We verklaren Numatic hierbij op eigen verantwoordelijkheid, dat het bovengenoemde product voldoet aan de volgende richtlijnen en normen	SL Mi, Numatic izjavljamo s polno odgovornostjo, da je zgoraj omenjeni izdelek v skladu z naslednjimi smernicami in standardi.
FR Numatic déclare sous notre seule responsabilité que le produit mentionné ci-dessus est conforme aux directives et normes suivantes.	NO Vi, Numatic erklærer herved under eget ansvar, at det ovennevnte produktet er i samsvar med følgende direktiver og standarder	FI Me, Numatic täten vakuutamme omalla vastuulla, että edellä mainittu tuote on yhdenmukainen seuraavien direktiivien ja standardien mukaisesti
2006/42/EC	Machinery Directive	EN60335-1:2012 + AC:2014 + A11:2014 + A13:2017 + A15:2021 EN60335-2-72:2012 EN62233:2008
2014/30/EU	EMC Directive	EN55014-1:2017 + A11:2020 EN55014-2:1997 + A1:2001 + A2:2008
2011/65/EU	RoHS Directive	

Authorised Signatory: Mr. Matthew Coles

Position: Head of Technology

Numatic International Limited
Chard,
Somerset, TA20 2GB, UK

Signed:  Date: 28th April 2025

This Machine Has Been Packed
With The Following

Brush / Pad

☐

Floor Tool

☐

Battery & Charger Manual

☐

Battery Charger & Lead

☐

Battery

☐

Signed

Distributed by:

Numatic

numatic.com

**Numatic International Limited
(Head Office)**

Chard, Somerset TA20 2GB, UNITED
KINGDOM

Tel: 01460 68600 numatic.com

Numatic International GmbH

Fränkische Straße 15-19, 30455 Hannover,
DEUTSCHLAND

Tel: +49 (0) 511 984 2160 numatic.de

Numatic International Denmark

Fränkische Straße 15-19, 30455 Hannover,
DEUTSCHLAND

Tel: +45 (0) 316 40808 numatic-online.dk

Numatic International S.A.S

13/17 rue du Valengelier, EAE la Tuilerie,
77500 Chelles, FRANCE

Tel: +33 (0) 164 726 161 numatic.fr

Numatic International BV

Vennootsweg 15, 2404 CG, Alphen aan den
Rijn, NEDERLAND

Tel: +31 (0) 172 467 999 numatic.nl

Numatic International Schweiz AG.

Sihlbruggstrasse 3A, 6340 Baar, SCHWEIZ

Tel: +41 (0) 41 768 0760 numatic.ch

Numatic International (PTY) Ltd.

Cnr. 16th & Pharmaceutical Road, Randjes
Park, Midrand 1685, SOUTH AFRICA

Tel: +27 (0) 861 686 284 numatic.co.za

Numatic International ULDA

Rua Francisco da Silva Duarte, nº79,
4475-269 Santa Maria de Avioso, Castelo da
Maia, PORTUGAL

Tel: +351 220 047 700 numatic.pt

Numatic International Spain, S.L.U.

Av. Baix Llobregat, 5-7, Oficina bajos 1 (Parc
Negocis Mas Blau II)

08820 El Prat de Llobregat (Barcelona),
SPAIN

Tel: +34 93 647 22 22 numatic.es

Numatic International Italy S.R.L

Via Luigi Galvani, 2, Z.I. Talponedo, 33080
Porcia (PN), ITALY

Tel: +39 (0) 434 046 211 numatic.it

Edco, Edgar Edmondson Pty Ltd

Head Office: PO Box 198, Marrickville, NSW
1475, AUSTRALIA

Delivery & Shipping Address
18 Garden St, Marrickville, NSW 2204,
AUSTRALIA

Office Number: +61 (0)2 9557 4411,

Fax Number: +61 (0)2 9519 9223,

Email: orders@edmondson.net.au

ABN: 27 000 450 144

Proquip NZ Ltd

7a Peterkin Street, Taita Lower Hutt, 5019

Tel: +64 4 566 7847, Fax: +64 4 576 0430

Web: www.proquipnz.co.nz

This Product has been comprehensively inspected and checked during every stage of its manufacture.
Including an in-depth electrical safety and functionality test.

Specification subject to change without prior notice. All rights reserved.

numatic.com © Numatic International Limited

920511 05/25 (A01)